

AL480ZIS

Refrigerator
冰箱用户手册



Please read this manual before using the product!

Dear Valued Customer,





We wish you to get the best results from your product that has been manufactured meticulously at modern plants and tested with detailed quality control checks.

For this reason, we recommend that you read this user manual thoroughly before starting the product. If you hand over the product to someone else, please remember to give the user manual as well.

This manual will help you use your appliance in a fast and safe way.

- Please read this user manual carefully before installing and using the product.
- Always follow the applicable safety instructions.
- Keep the user manual in an easily accessible place for further use.
- Please read all the other documents provided with the product.

Please keep in mind that this manual may apply to several product models. This manual expressly indicates the differences between various models.

	Important information and useful hints.
	Risk of injury and property damage.
	Risk of electric shock.
	Packaging materials of this product has been manufactured from recyclable materials in accordance with the National Environment Regulations.

1 Important Instructions Regarding Safety and Environment

3

- 1.1. General Safety 3
- 1.1.1 Hydrocarbon (HC) Warning 5
- 1.1.2 For Products with a Water Dispenser/Ice Machine 5
- 1.2. Intended Use 6
- 1.3. Children's Safety 6
- 1.4. Compliance with the WEEE Directive and Disposing the Waste Product: 6
- 1.5. Compliance with the RoHS Directive: 6
- 1.6. Packaging Information 6

2 Your appliance

8

3 Installation

9

- 3.1. Appropriate location for installation 9
- 3.2. Installing the plastic wedges 9
- 3.3. Adjusting the feet 10
- 3.4. Electrical connection 10

4 Preparation

11

- 4.1. Things to be done for energy saving 11
- 4.2. Initial use 11

5 Operating the product

12

- 5.1. Indicator panel 12
- 5.2. Indicator panel 17
- 5.3. Ice machine 21
- 5.4. Icematic 21
- 5.5. Ice container 21
- 5.6. Blue light 22
- 5.7. Deodorising Module 22
- (FreshGuard) 22
- 5.8. Ionizer 22
- 5.9. Chiller compartment 23
- 5.10. Crisper 23
- 5.11. Movable Middle Section 23
- 5.12. Using the water dispenser 24
- 5.13. Filling the water dispenser's tank 24
- 5.14. Cleaning the water tank 25
- 5.15. Drip tray 25
- 5.16. Everfresh (Humidity-controlled crisper) 26
- 5.17. Freezing fresh food 27
- 5.18. Recommendations for preserving the frozen food 28
- 5.19. Deep-freeze information 28
- 5.20. Placing the food 28
- 5.21. Door open warning 28
- 5.22. Illumination lamp 28

6 Care and Cleaning

29

- 6.1. Avoiding Bad Odours 29
- 6.2. Protection of plastic surfaces 29
- 6.3. Cleaning the Inner Surface 29
- 6.4. Stainless Steel Outer Surfaces 29

6 Care and Cleaning

30

- 6.5. Cleaning Products with Glass Doors 30





7 Troubleshooting

31

1 Important Instructions Regarding Safety and Environment

This chapter contains safety information that will help you avoid the risk personal injury or property damage. Failure to follow these instructions shall render any product warranty void.

Intended use

	WARNING: Keep ventilation openings, in the appliance enclosure or in the built-in structure, clear of obstruction.
	WARNING: Do not use mechanical devices or other means to accelerate the defrosting process, other than those recommended by the manufacturer.
	WARNING: Do not damage the refrigerant circuit.
	WARNING: Do not use electrical appliances inside the food storage compartments of the appliance, unless they are of the type recommended by the manufacturer.

This appliance is intended to be used in household and similar applications such as

- staff kitchen areas in shops, offices and other working environments;
- farm houses and by clients in hotels, motels and other residential type environments;
- bed and breakfast type environments;
- catering and similar non-retail applications.

1.1. General Safety

- Persons with physical, sensory or mental disabilities; persons who lack experience and information and children should not approach, enter or play with the product.
- Failure to follow the instructions and uncontrolled use of the product lead to dangerous results!
- Unplug the product if you encounter a failure during use.
- If the product malfunctions, it must not be operated until repaired by the authorised service provider. Risk of electric shock!
- Plug the product into a grounded socket protected by a fuse that corresponds to the value on its nameplate. Have a qualified electrician ground the product. Our company cannot be held responsible for damages resulting from the failure to use the product with a grounded socket pursuant to local regulations.
- Unplug the product when not in use.
- Never wash the product by spreading or pouring water onto it! Risk of electric shock!
- Never touch the plug with wet hands!
- Never unplug the product by pulling the cable. Always pull the plug by holding the socket.

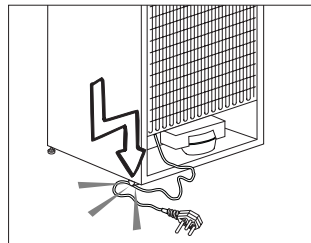

- Do not plug the refrigerator if the wall socket is loose.

Instructions for safety and environment

- Never connect your refrigerator to energy saving devices. Such systems are harmful to your product.
- Unplug the product during installation, care, cleaning and repairing procedures.
- Always have the **Authorised Service Provider** install the product and establish its electrical connections. The manufacturer cannot be held responsible for damages caused by procedures performed by unauthorised persons.
- Do not eat cone ice cream or ice cubes immediately after you take them out of the freezer compartment! This may cause frostbite in your mouth!
- Do not touch frozen food with wet hands! They may stick to your hand!
- Do not put bottled or canned liquid beverages in the freezer compartment. They may burst!
- Never use steam or steam cleaners to clean or defrost the refrigerator. Steam gets into contact with the live parts in your refrigerator, causing short circuit or electric shock!
- Do not use mechanical devices or other means to accelerate the defrosting process other than those recommended by the manufacturer.
- Never use the parts in your refrigerator such as the door and drawer as a means of support or step. This may cause the product to tip over or damage the parts of it.
- Do not damage the parts where the refrigerant is circulating with drilling or cutting tools. The refrigerant that might blow out when the gas channels of the evaporator, pipe extensions or surface coatings are punctured causes skin irritations and eye injuries.
- Do not cover or block the ventilation holes in your refrigerator with any object.
- Place the beverage with higher proofs tightly closed and vertically.
- Do not use gaseous sprays near the product since there is the risk of fire or explosion!
- Flammable items or products that contain flammable gases (e.g. spray) as well as explosive materials should never be kept in the appliance.
- Do not place vessels filled with liquid onto the product. Splashing water on an electrical part may cause electric shock or the risk of fire.
- Do not store items that need precise temperature adjustment (such as vaccines, heat-sensitive medication, science materials etc.) in the refrigerator.
- If you are not going to use the product for a long time, unplug it and remove the food in it.
- If there is a blue light on the refrigerator, do not look at this light with optical tools.
- Exposing the product to rain, snow, sun or wind is dangerous in terms of electrical safety.
- In products with mechanical control (thermostat), wait for 5 minutes to plug in the product again after unplugging.

Instructions for safety and environment

- Do not overload the refrigerator. Objects in the refrigerator may fall down when the door is opened, causing injury or damage. Similar problems may arise if any object is placed onto the product.
- If the product has a door handle, do not pull the handle when re-locating the product. The handle might be loose.
- Be careful not to jam your hand or any other body part in the moving parts of the refrigerator.
- Do not put your hand or any other foreign materials into the ice machine while it is operating.

1.1.1 Hydrocarbon (HC) Warning

- If your product's cooling system contains R600a:

This gas is flammable. Therefore, pay attention not to damage the cooling system or the piping during use and transportation. If damaged, keep the product away from potential fire sources that may cause it to catch fire and ventilate the room where the product is placed.



If the product is damaged and if you see gas leak, please keep away from the gas. It may cause frostbite when it gets into contact with the skin. (including R134)



Ignore this warning if the cooling system of your product contains R134a.



Type of gas used in the product is stated on the type plate which is on the left wall inside the refrigerator.



WARNING:

Never throw the product into fire for disposal.

1.1.2 For Products with a Water Dispenser/Ice Machine

- Pressure for cold water inlet shall be maximum 90 psi (620 kPa). If your water pressure exceeds 80 psi (550 kPa), use a pressure limiting valve in your mains system. If you do not know how to check your water pressure, ask for the help of a professional plumber.
- If there is a risk of water impact in your installation, always use a water impact protection equipment in that installation. Please consult professional plumbers if you are not sure if there is water impact in your installation.
- Do not make installation on the hot water inlet.
- Use drinking water only.
- Take the necessary measures against the freezing risk of the hoses. The water temperature operating range must be 0.6°C (33°F) minimum and 38°C (100°F) maximum.

Instructions for safety and environment



WARNING:

Never connect the product to a cold water mains with a pressure of 550 kPa (80 psi) or above.

1.2. Intended Use

- This product has been designed for domestic use. It is not suitable for commercial use and it must not be used out of its intended use.
- It must be used only for storing food.
- The manufacturer will not take any responsibility for damages resulting from improper use or transport.
- Original spare parts will be available for 10 years after the purchase date of the product.

1.3. Children's Safety

- If there is a lock on the door of the product, the key should be kept out of the reach of children.
- Do not let children play with the product.



DANGER:

Before disposing your old refrigerator or freezer:

- Children may get locked inside.
- Remove the doors.
- Leave the shelves to prevent children from getting inside the product easily.

1.4. Compliance with the WEEE Directive and Disposing the Waste Product:



This product conforms to the EU WEE Directive (2012/19 EU). This product bears a classification symbol for waste electrical and electronic equipment (WEEE). This product has been manufactured from high quality parts and materials which can be reused and are suitable for recycling. Therefore, do not dispose the product with normal domestic waste or other waste at the end of its service life. Take it to a collection centre for recycling electrical and electronic equipment. Please consult local authorities to learn about the locations of such collection centres.

1.5. Compliance with the RoHS Directive:

The unit you have purchased conforms to the EU RoHS Directive (2011/65/EU). It does not contain harmful or prohibited materials specified in the Directive.

1.6. Packaging Information

- Packaging materials of the product have been manufactured from recyclable materials in accordance with our National Environment Regulations. Do not dispose the packaging materials with normal domestic waste or other types of waste. Take these materials to a recycling point designated by local authorities.

Instructions for safety and environment



DANGER:

Risk of Fire or Explosion:

- This product uses flammable refrigerant.
- Do not use mechanical devices to defrost the refrigerator.
- Do not use chemicals for cleaning.
- Do not pierce the refrigerant pipe.
- If the refrigerant pipe is pierced, it must be repaired only by licensed service personnel.
- Please consult the repair/user manual before cleaning the product. All safety instructions must be followed.
- Dispose the product according to federal or local regulations.

2 Your appliance

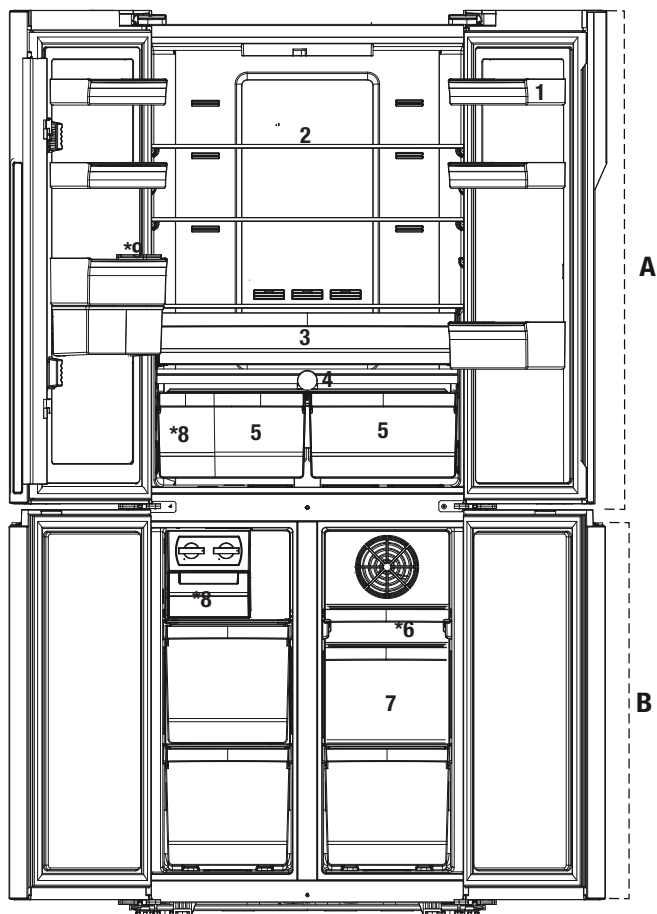

A- Cooler compartment

B- Freezer compartment

1- Door shelves of fridge compartment

2- Fridge compartment glass shelf

3- Chiller compartment

4- Everfresh

5- Crisper

6- Freezer compartment movable drawer

7- Freezer compartment drawers

8- Auto Icematic

9- Water reservoir

It may not apply to all models.



Figures in this user manual are given as an example and may not match the product exactly. If the relevant parts are not available in the product you purchased, the figure applies to other models.

3.1. Appropriate location for installation

Contact an Authorized Service for the installation of the product. In order to prepare the product for use, refer the information in the user manual and ensure that electrical installation and water installation are appropriate. If not, call a qualified electrician and technician to have any necessary arrangements carried out.



WARNING: Manufacturer shall not be held liable for damages that may arise from procedures carried out by unauthorized persons.



WARNING: Product must not be plugged in during installation. Otherwise, there is the risk of death or serious injury!



WARNING: : If the door clearance of the room where the product shall be placed is so tight to prevent passing of the product, contact the authorized service.

- Place the product on a level floor surface to prevent jolts.
- If you will use the product within a cabinet/furniture, leave a clearance of minimum 2 cm between the side walls and the cabinet/furniture.
- Install the product at least 30 cm away from heat sources such as hobs, heater cores and stoves and at least 5 cm away from electrical ovens.
- Product must not be subjected to direct sun light and kept in humid places.
- Appropriate air ventilation must be provided around your product in order to achieve an efficient operation. If the product is to be placed in a recess in the wall, pay attention to leave at least 5 cm distance with the ceiling and the side walls. **For versions which do not have plastic wedges, make sure that a clearance of 5 cm is left from the rear wall.**
- In environments where the room temperature drops below 10 °C, the refrigerator continues to operate to preserve the food in the freezer. However, the fresh food in the fridge compartment may freeze due to the cold environment.

3.2. Installing the plastic wedges

Plastic wedges supplied with the product are used to create the distance for the air circulation between the product and the rear wall.

1. To install the wedges, remove the screws on the product and use the screws supplied together with the wedges.

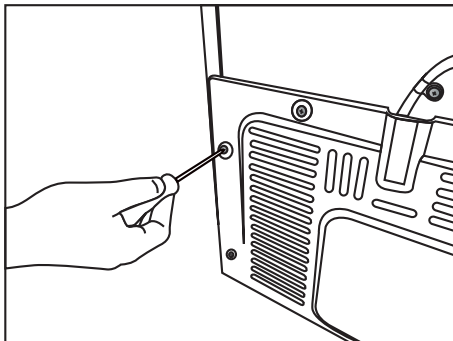

2. Insert the 2 plastic wedges onto the rear ventilation cover as illustrated in the figure.

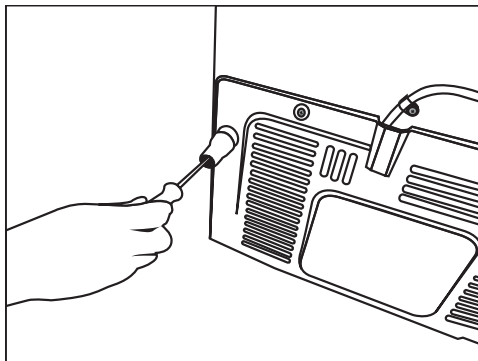

Installation

3.3. Adjusting the feet

If the product stands unbalanced after installation, adjust the feet on the front by rotating them to the right or left.

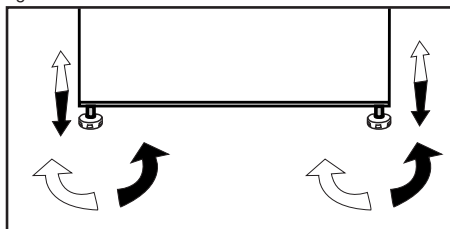

3.4. Electrical connection

	WARNING: Do not make connections via extension cables or multi-plugs.
	WARNING: Damaged power cable must be replaced by the Authorized Service Agent.
	If two coolers are to be installed side by side, there should be at least 4 cm distance between them.

- Our company shall not be liable for any damages that will arise when the product is used without grounding and electrical connection in accordance with the national regulations.
- Power cable plug must be within easy reach after installation.
- Do not use extension cords or cordless multiple outlets between your product and the wall outlet.

	Warning for hot surfaces! The side walls of your product are equipped with coolant pipes to improve the cooling system. The high temperature fluid may flow through these surfaces and may heat the surfaces on the side walls. This is normal and does not require service maintenance. Be careful when touching these areas.
--	--

4.1. Things to be done for energy saving



Connecting the product to electric energy saving systems is risky as it may cause damage on the product.

- Do not leave the doors of your refrigerator open for a long time.
- Do not put hot food or drinks in your refrigerator.
- Do not overload the refrigerator, cooling capacity will fall when the air circulation inside is hindered.
- To be able to store the maximum amount of food in the freezer compartment of your refrigerator, remove the icebox and the ice container and place them on top of the glass shelf. The power consumption stated for your refrigerator was determined after removing the icebox, ice container, and upper and middle drawers to allow maximum loading. Using the lower drawer while loading is highly recommended.
- Depending on the features of your product, thawing frozen food in fridge compartment will both provide energy saving and preserve the food quality.
- Airflow should not be blocked by placing foods in front of the freezer compartment fan. Foods should be loaded by leaving minimum 5 cm space in front of the protective fan grid.
- The temperature sensor in the freezer compartment must be prevented from directly contacting food packages. If they get in contact, the power consumption of the product may increase.



Inside of your product must be cleaned.



If two coolers are to be installed side by side, there should be at least 4 cm distance between them.

4.2. Initial use

Before starting to use your refrigerator, ensure that all preparations are made in accordance with the instructions in sections "Instructions for safety and environment" and "Installation".

Run the product without putting any food for 6 hours and do not open its door unless certainly required.



You will hear a noise when the compressor starts up. The liquids and gases sealed within the refrigeration system may also give rise to noise, even if the compressor is not running and this is normal.



It is normal that the front edges of the refrigerator are hot. These areas are designed to be warm to avoid condensation.

5.1. Indicator panel

Indicator panels may vary according to the product model.

Audio – visual functions on the indicator panel helps you in using your product.

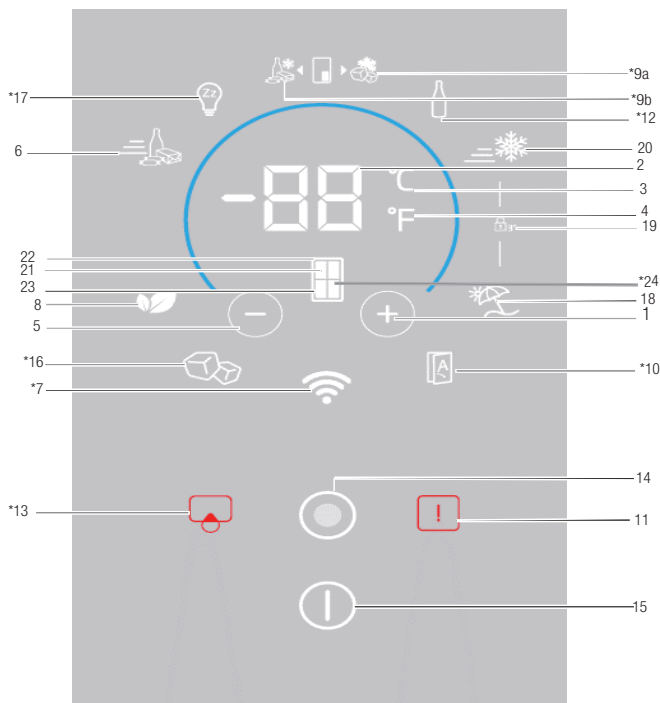

- | | |
|---|--|
| 1. Temperature Setting/Temperature Increase | 13. *Filter Replacement Warning/Button |
| 2. Temperature Setting-Slider/Temperature value indicator | 14. Menu Button |
| 3. Temperature Unit Selection (°C) Celsius indicator | 15. Product On/Off indicator/button |
| 4. Temperature Unit Selection (°F) Fahrenheit indicator | 16. *Icematic indicator/button |
| 5. Temperature Setting/Temperature Decrease | 17. *Sabbath Mode |
| 6. Quick Cooling function indicator/button | 18. Vacation Mode indicator/button |
| 7. * Wireless | 19. Key Lock indicator |
| 8. Economy Mode indicator/button | 20. Quick Freeze function indicator/button |
| 9. *Joker Freezer indicator/button | 21. Cabinet Selection |
| 10. *Auto Door | 22. Fridge compartment indicator |
| 11. High Temperature Warning/Failure | 23. Freezer compartment indicator |
| 12. *Bottle Cooler | 24. *Joker compartment indicator |

It may not apply to all models.



***Optional:** Figures in this user manual are given as an example and may not match the product exactly. If the relevant parts are not available in the product you purchased, the figure applies to other models.

Operating the product

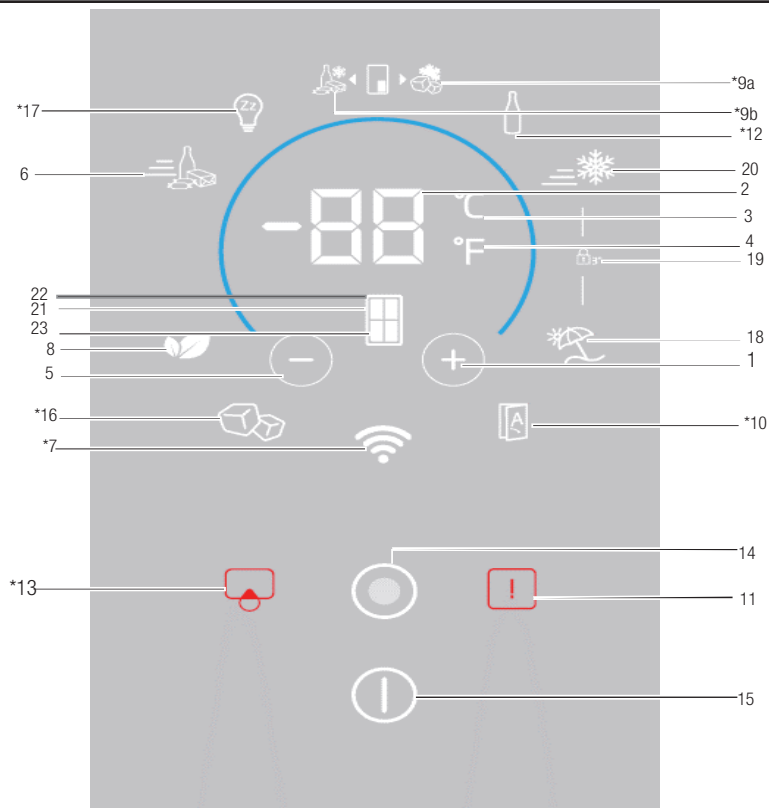

- | | |
|---|--|
| 1. Temperature Setting/Temperature Increase | 13. *Filter Replacement Warning/Button |
| 2. Temperature Setting-Slider/Temperature value indicator | 14. Menu Button |
| 3. Temperature Unit Selection (°C) Celsius indicator | 15. Product On/Off indicator/button |
| 4. Temperature Unit Selection (°F) Fahrenheit indicator | 16. *Icematic indicator/button |
| 5. Temperature Setting/Temperature Decrease | 17. *Sabbath Mode |
| 6. Quick Cooling function indicator/button | 18. Vacation Mode indicator/button |
| 7. * Wireless | 19. Key Lock indicator |
| 8. Economy Mode indicator/button | 20. Quick Freeze function indicator/button |
| 9. *Joker Freezer indicator/button | 21. Cabinet Selection |
| 10. *Auto Door | 22. Fridge compartment indicator |
| 11. High Temperature Warning/Failure | 23. Freezer compartment indicator |
| 12. *Bottle Cooler | |

It may not apply to all models.



***Optional:** Figures in this user manual are given as an example and may not match the product exactly. If the relevant parts are not available in the product you purchased, the figure applies to other models.

Operating the product

1. Temperature Setting/Temperature Increase

It increases the temperature of the selected compartment when pressed.

2. Temperature Setting-Slider/Temperature value indicator

It shows the temperature value of the selected compartment. Moreover, you can slide your finger top-down or down-top to increase or decrease the temperature value.

3. Temperature Unit Selection (°C)

Celsius indicator

When this button is pressed, the temperature value will be activated as Celsius.

It is the Celsius indicator. When Celsius indication has been activated, temperature set values will be shown in Celsius and the relevant icon will turn on completely;

the Fahrenheit icon will turn on by 50%.

4. Temperature Unit Selection (°F)

Fahrenheit indicator

When this button is pressed, the temperature value will be activated as Fahrenheit.

It is the Fahrenheit indicator. When Fahrenheit indication has been activated, temperature set values will be shown in Fahrenheit and the relevant icon will turn on completely;

the Celsius icon will turn on by 50%.

5. Temperature Setting/Temperature Decrease

It decreases the temperature of the selected compartment when pressed.

6. Quick cooling function indicator

When the Quick Cooling function has been activated, the indicator will turn on completely. When the function has been cancelled, the product will return to its usual settings and the indicator will turn on by 50%.

Quick cooling function button

It is used to activate or deactivate the quick cooling function.



Use quick cooling function when you want to quickly cool the food placed in the fridge compartment. If you want to cool large amounts of fresh food, activate this function before putting the food into the product.



If you do not cancel it, quick cooling will cancel itself automatically after 8 hours at the most or when the fridge compartment reaches to the required temperature.



If you press the quick cooling button repeatedly with short intervals, the electronic circuit protection will be activated and the compressor will not start up immediately.



This function is not recalled when power restores after a power failure.

7. Wireless

When this button is pressed, the product will be introduced to the home network for the first time. Once the function has been activated, the indicator will turn on by 100%; and if the function has been cancelled, it will turn on by 50%.

8. Economy Mode indicator/button

Press this button to activate/deactivate the economy mode.

Once the economy mode has been activated, the indicator will turn on by 100%. While the function is active, the freezer will start to work on economy mode after at least 6 hours. Once the function has been cancelled, the indicator will turn on by 50%.

9a. *Joker Freezer indicator/button

Once the button has been pressed, the joker compartment will function as a freezer and the indicator will turn on by 100%. The joker fridge indicator will turn on by 50%.

9b. *Joker fridge indicator/button

Once the button has been pressed, the joker compartment will function as a fridge and the indicator will turn on by 100%. The joker freezer indicator will turn on by 50%.

10.* Auto Door

Press this button to activate/deactivate the auto door mode. Once the function has been activated, the indicator will turn on by 100%. Once the function has been cancelled, the indicator will turn on by 50%.

Operating the product

While the function is active, touch the relevant section on the door handle to open the door automatically.

11. High Temperature Warning/Failure

This indicator illuminates during power failure, high temperature failures and error warnings. During long-term power failures, the highest temperature value that the freezer compartment reaches will blink on the digital display. After checking the food located in the freezer compartment, press the high temperature warning button to clear the warning.

12. *Bottle Cooler

Press this button to activate/deactivate the bottle cooler mode.

Once the function has been cancelled, the indicator will turn on by 100%. If the function is cancelled, the indicator will turn on by 50%.

13. *Filter Replacement Warning/Button

This icon turns on when the filter needs to be reset.

Once this button is pressed, the filter will be reset and the reset icon will go off.

14. Menu Button

Use this button to switch the display to sleep mode or cancel the sleep mode. If you do not press any button or open the door for 30 seconds, it will automatically switch to sleep mode.

15. Product On/Off indicator/button

To turn on/off the product, press and hold the On/Off button for 3 seconds.

After the product has been turned off, only the on/off indicator will turn on by 100%; all the other indicators will go off. To turn on the product, press and hold the same button for 3 seconds. The refrigerator will become active and the on/off indicator will turn on by 50%.

16. *Icematic indicator/button

Press this button to activate/deactivate the icematic. If the indicator is on by 100%, this means that the icematic is working. If the indicator is on by 50%, this means that the icematic is off.



Water flow from water tank will stop when this function is not selected. However, ice made previously can be taken from the icematic.

17. *Sabbath Mode

Press this button to activate/deactivate the Sabbath mode. Once the function has been activated, the indicator will turn on by 100%. Once the function has been cancelled, the indicator will turn on by 50%.

18. Vacation Mode indicator/button

Press this button to activate the vacation button; the vacation mode indicator will turn on by 100%. When the vacation function is active, “- -” will be displayed on the Temperature Value display and no active cooling will be performed in the fridge compartment. It is not suitable to keep the food in the fridge compartment when this function is activated. Other compartments will continue to be cooled according to their set temperatures.

To cancel this function, press the **Vacation function** button again. Once the function has been cancelled, the indicator will turn on by 50%.

19. Key Lock indicator

Press **quick cooling** and **vacation** buttons simultaneously for 3 seconds. While pressing the button, a countdown will start on the temperature value display. Once the key lock has been activated, the key lock indicator will turn on by 100% and the key lock mode will become activated. Buttons will not function if the Key lock mode is active. Press **quick cooling** and **vacation** buttons again simultaneously for 3 seconds. While pressing the button, a countdown will start on the temperature value display. Once the key lock has been cancelled, the key lock indicator will turn on by 50% and the key lock mode will be deactivated.

Activate this function if you want to prevent changing of the temperature setting of the refrigerator.

20.Quick freeze function indicator

When the Quick Freeze function has been activated, the indicator will turn on by 100%. When the function has been cancelled, the product will return to its usual settings and the indicator will turn on by 50%.

Quick freeze function button

It is used to activate or deactivate the quick freeze function.

Operating the product

Press this button to activate or deactivate the quick freeze function. When you activate the function, the freezer compartment will be cooled to a temperature lower than the set value.



Use the quick freeze function when you want to quickly freeze the food placed in freezer compartment. If you want to freeze large amounts of fresh food, activate this function before putting the food into the product.



If you do not cancel it, Quick Freeze will cancel itself automatically after 4 hours at the most or when the fridge compartment reaches to the required temperature.



This function is not recalled when power restores after a power failure.

21. Cabinet Selection

Press the cabinet selection button to see and change the temperature value of the fridge or freezer on the Temperature value indicator.

22. Fridge compartment indicator

When this indicator is active, temperature of the fridge compartment will be displayed on the temperature value indicator.

23. Freezer compartment indicator

When this indicator is active, temperature of the freezer compartment will be displayed on the temperature value indicator.

24.*Joker compartment indicator

When this indicator is active, temperature of joker freezer compartment will be displayed on the temperature value indicator.

Operating the product

5.2. Indicator panel

Indicator panels may vary according to the product model.

Audio – visual functions on the indicator panel helps you in using your product.

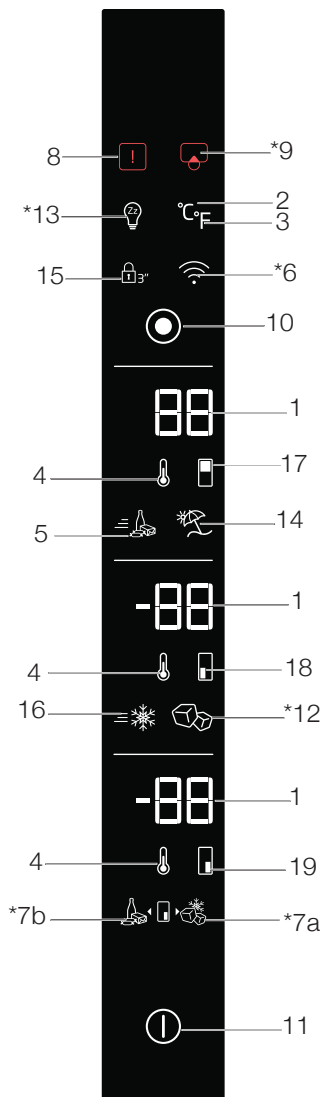

It may not apply to all models.



***Optional:** Figures in this user manual are given as an example and may not match the product exactly. If the relevant parts are not available in the product you purchased, the figure applies to other models.

Operating the product

1. Temperature Setting-Slider/Temperature value indicator
2. Temperature Unit Selection (°C) Celsius indicator
3. Temperature Unit Selection (°F) Fahrenheit indicator
4. Temperature Setting/Temperature Decrease
5. Quick Cooling function indicator/button
6. * Wireless
7. *Joker Freezer indicator/button
8. High Temperature Warning/Failure
9. *Filter Replacement Warning/Button
10. Menu Button
11. Product On/Off indicator/button
12. *Icematic indicator/button
13. *Sabbath Mode
14. Vacation Mode indicator/button
15. Key Lock indicator
16. Quick Freeze function indicator/button
17. Fridge compartment indicator
18. Freezer compartment indicator
19. *Joker compartment indicator

1. Temperature Setting-Slider/Temperature value indicator

It shows the temperature value of the selected compartment. Moreover, you can slide your finger top-down or down-top to increase or decrease the temperature value.

2. Temperature Unit Selection (°C) Celsius indicator

When this button is pressed, the temperature value will be activated as Celsius.

It is the Celsius indicator. When Celsius indication has been activated, temperature set values will be shown in Celsius and the relevant icon will turn on completely;

the Fahrenheit icon will turn on by 50%.

3. Temperature Unit Selection (°F) Fahrenheit indicator

When this button is pressed, the temperature value will be activated as Fahrenheit.

It is the Fahrenheit indicator. When Fahrenheit indication has been activated, temperature set values will be shown in Fahrenheit and the relevant icon will turn on completely;

the Celsius icon will turn on by 50%.

4. Temperature Setting/Temperature Decrease

It decreases the temperature of the selected compartment when pressed.

5. Quick cooling function indicator

When the Quick Cooling function has been activated, the indicator will turn on completely. When the function has been cancelled, the product will return to its usual settings and the indicator will turn on by 50%.

Quick cooling function button

It is used to activate or deactivate the quick cooling function.



Use quick cooling function when you want to quickly cool the food placed in the fridge compartment. If you want to cool large amounts of fresh food, activate this function before putting the food into the product.



If you do not cancel it, quick cooling will cancel itself automatically after 8 hours at the most or when the fridge compartment reaches to the required temperature.



If you press the quick cooling button repeatedly with short intervals, the electronic circuit protection will be activated and the compressor will not start up immediately.



This function is not recalled when power restores after a power failure.

6. Wireless

When this button is pressed, the product will be introduced to the home network for the first time. Once the function has been activated, the indicator will turn on by 100%; and if the function has been cancelled, it will turn on by 50%.

7a. *Joker Freezer indicator/button

Once the button has been pressed, the joker compartment will function as a freezer and the indicator will turn on by 100%. The joker fridge indicator will turn on by 50%.

Operating the product

7b. *Joker fridge indicator/button

Once the button has been pressed, the joker compartment will function as a fridge and the indicator will turn on by 100%. The joker freezer indicator will turn on by 50%.

8. High Temperature Warning/Failure

This indicator illuminates during power failure, high temperature failures and error warnings. During long-term power failures, the highest temperature value that the freezer compartment reaches will blink on the digital display. After checking the food located in the freezer compartment, press the high temperature warning button to clear the warning.

9. *Filter Replacement Warning/Button

This icon turns on when the filter needs to be reset. Once this button is pressed, the filter will be reset and the reset icon will go off.

10. Menu Button

Use this button to switch the display to sleep mode or cancel the sleep mode. If you do not press any button or open the door for 30 seconds, it will automatically switch to sleep mode.

11. Product On/Off indicator/button

To turn on/off the product, press and hold the On/Off button for 3 seconds.

After the product has been turned off, only the on/off indicator will turn on by 100%; all the other indicators will go off. To turn on the product, press and hold the same button for 3 seconds. The refrigerator will become active and the on/off indicator will turn on by 50%.

12. *Icematic indicator/button

Press this button to activate/deactivate the icematic. If the indicator is on by 100%, this means that the icematic is working. If the indicator is on by 50%, this means that the icematic is off.



Water flow from water tank will stop when this function is not selected. However, ice made previously can be taken from the icematic.

13. *Sabbath Mode

Press this button to activate/deactivate the Sabbath mode. Once the function has been activated, the indicator will turn on by 100%. Once the function has been cancelled, the indicator will turn on by 50%.

14. Vacation Mode indicator/button

Press this button to activate the vacation button; the vacation mode indicator will turn on by 100%. When the vacation function is active, “- -” will be displayed on the Temperature Value display and no active cooling will be performed in the fridge compartment. It is not suitable to keep the food in the fridge compartment when this function is activated. Other compartments will continue to be cooled according to their set temperatures.

To cancel this function, press the **Vacation function** button again. Once the function has been cancelled, the indicator will turn on by 50%.

15. Key Lock indicator

Press **quick cooling and vacation** buttons simultaneously for 3 seconds. While pressing the button, a countdown will start on the temperature value display. Once the key lock has been activated, the key lock indicator will turn on by 100% and the key lock mode will become activated. Buttons will not function if the Key lock mode is active. Press quick cooling and vacation buttons again simultaneously for 3 seconds. While pressing the button, a countdown will start on the temperature value display. Once the key lock has been cancelled, the key lock indicator will turn on by 50% and the key lock mode will be deactivated.

Activate this function if you want to prevent changing of the temperature setting of the refrigerator.

16.Quick freeze function indicator

When the Quick Freeze function has been activated, the indicator will turn on by 100%. When the function has been cancelled, the product will return to its usual settings and the indicator will turn on by 50%.

Quick freeze function button

It is used to activate or deactivate the quick freeze function.

Press this button to activate or deactivate the quick freeze function. When you activate the function, the freezer compartment will be cooled to a temperature lower than the set value.

Operating the product



Use the quick freeze function when you want to quickly freeze the food placed in freezer compartment. If you want to freeze large amounts of fresh food, activate this function before putting the food into the product.



If you do not cancel it, Quick Freeze will cancel itself automatically after 4 hours at the most or when the fridge compartment reaches to the required temperature.



This function is not recalled when power restores after a power failure.

17. Fridge compartment indicator

When this indicator is active, temperature of the fridge compartment will be displayed on the temperature value indicator.

18. Freezer compartment indicator

When this indicator is active, temperature of the freezer compartment will be displayed on the temperature value indicator.

19.*Joker compartment indicator

When this indicator is active, temperature of joker freezer compartment will be displayed on the temperature value indicator.

Operating the product

5.3. Ice machine

(This feature is optional)

Ice machine allows you to obtain ice from the product easily.

Using the ice machine

1. Remove the water tank from the fridge compartment.
2. Fill the water tank with water.
3. Replace the water tank. First ice cubes will be ready in approximately four hours in the ice machine drawer located in the freezer compartment.



While the water tank is completely filled, you will be able to obtain approximately 60-70 ice cubes.



The water within the tank should be renewed in every 2-3 weeks.

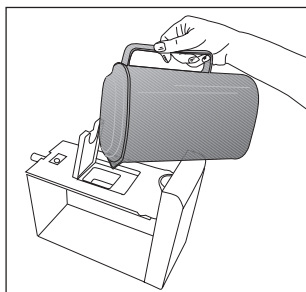
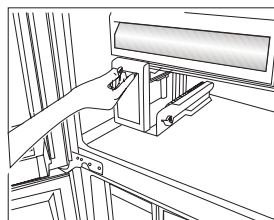
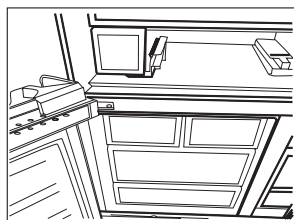

5.4. Icematic

(This feature is optional)

Icematic allows you to obtain ice from the product easily.

Using the icematic

1. Take out the icematic pulling it out carefully.
2. Fill the icematic with water.
3. Place the icematic in place. About two hours later, the ice is ready.
4. To obtain ice, turn the knobs on the ice reservoirs clockwise by 90° degrees. Ice cubes in the reservoirs will fall down into the ice storage container below.
5. You may take out the ice storage container and serve the ice cubes.



Do not remove the Icematic from its seating to obtain ice.



If you wish, you may keep the ice cubes in the ice storage container. The ice storage container is just for accumulating ice cubes. Do not put water in it. Otherwise, it will break.

5.5. Ice container

(This feature is optional)

Icematic allows you to obtain ice from the product easily.

Using the ice container

1. Remove the ice container from the freezer compartment.
2. Fill the ice container with water.
3. Place the ice container in the freezer compartment. About two hours later, the ice is ready.
4. Remove the ice container from the freezer compartment and bend it over the service plate. Ice cubes will easily fall down to the service plate.

Operating the product

5.6. Blue light

(This feature is optional)

Crispers of the product are illuminated with a blue light. Foodstuff stored in the crisper continue their photosynthesis by means of the wavelength effect of blue light and thus, preserve their freshness.

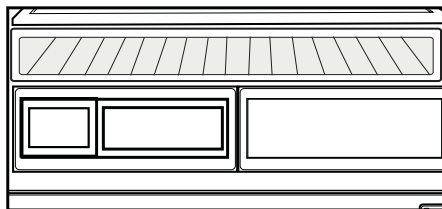

5.7. Deodorising Module

(FreshGuard)

(This feature is optional)

The deodorising module eliminates the bad odours in your refrigerator in a short while before they pervade the surfaces. Thanks to this module located in the ceiling of the fresh food compartment, the air actively passes over the odour filter, meanwhile bad odour molecules decompose, and the air that has come out after being cleaned is given back into the fresh food compartment. This way, the unwanted odours that may form while foods are being stored in the refrigerator can be eliminated before they pervade the surfaces.

This is achieved via the fan, LED and the odour filter in the module. In daily use, the deodorising module will get automatically activated for 2 hours every 48 hours on a periodical basis.

The noise that will be heard during operation due to the fan incorporated into the fan is normal. If the door of the fresh food compartment is opened while the module is active, the fan will stop temporarily and it will continue to operate after the door has been closed. In case of power failure, the deodorising module will resume operating where it has left off in a manner that the total operation time is 2 hours.

Info: To prevent bad odours that may emerge from the mixing of smells of different foods, we recommend you to store aromatic foods such as cheese, olives and delicatessen products in their sealed packages. For the safety of other foods stored and to prevent odours, we recommend you to remove the foods you have realised are spoiled from the refrigerator as soon as possible.



5.8. Ionizer

(This feature is optional)

The ionizer system in the cooler compartment's air duct serves to ionize the air. The negative ion emissions will eliminate bacteria and other molecules causing odour in the air.

Operating the product

5.9. Chiller compartment

(This feature is optional)

Use this compartment to store delicatessen that shall be stored in a lower temperature or meat products that you will consume in a short time. Do not store your fruits or vegetables in this compartment.

You can increase the inner volume of your product by removing any of the chiller compartments.

To remove, just pull the compartment until it stops, and then lift it and pull towards yourself.

5.10. Crisper

Crisper of the refrigerator is designed specially to keep the vegetables fresh without losing their humidity. For this purpose, cool air circulation is intensified around the crisper in general. Store your fruits and vegetables in this compartment. To preserve green leafy vegetables for a longer time, do not store them near fruits.

5.11. Movable Middle Section

Movable middle section is intended to prevent the cold air inside your refrigerator from escaping outside.

1- Sealing is provided when the gaskets on the door presses on the surface of the movable middle section while the fridge compartment doors are closed.

2- Another reason that your refrigerator is equipped with a movable middle section is that it increases the net volume of the fridge compartment. Standard middle sections occupy some non-usable volume in the refrigerator.

3- Movable middle section is closed when the left door of the fridge compartment is opened.

4- It must not be opened manually. It moves under the guidance of the plastic part on the body while the door is closed.

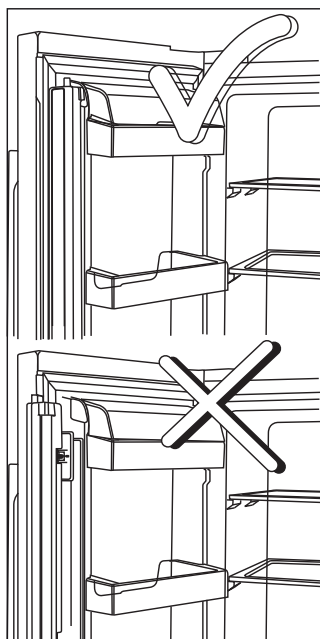

Operating the product

5.12. Using the water dispenser

(This feature is optional)

i It is normal for the first few glasses of water taken from the dispenser to be warm.

i If the water dispenser is not used for a long period of time, dispose of first few glasses of water to obtain fresh water.

1. Push in the lever of the water dispenser with your glass. If you are using a soft plastic cup, pushing the lever with your hand will be easier.
2. After filling the cup up to the level you want, release the lever.

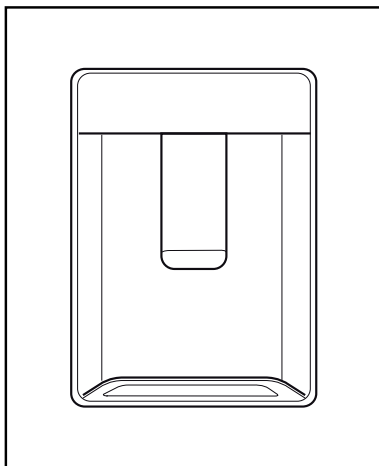

i Please note, how much water flows from the dispenser depends on how far you depress the lever. As the level of water in your cup / glass rises, gently reduce the amount of pressure on the lever to avoid overflow. If you slightly press the arm, the water will drip; this is quite normal and not a failure.

3. Close the cover.

i Do not fill the water tank with any other liquid except for water such as fruit juices, carbonated beverages or alcoholic drinks which are not suitable to use in the water dispenser. Water dispenser will be irreparably damaged if these kinds of liquids are used. Warranty does not cover such usages. Some chemical substances and additives contained in these kinds of drinks/liquids may damage the water tank.

i Use clean drinking water only.

i Capacity of the water tank is 3 liters; do not overfill.

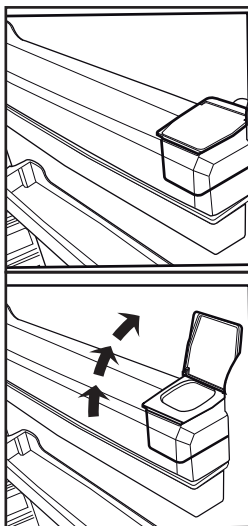

5.13. Filling the water dispenser's tank

Water tank filling reservoir is located inside the door rack.

1. Open the cover of the tank.
2. Fill the tank with fresh drinking water.

Operating the product

5.14. Cleaning the water tank

1. Remove the water filling reservoir inside the door rack.
2. Remove the door rack by holding from both sides.
3. Grab the water tank from both sides and remove it with an angle of 45°C.
4. Remove the cover of the water tank and clean the tank.



Components of the water tank and water dispenser should not be washed in dishwasher.

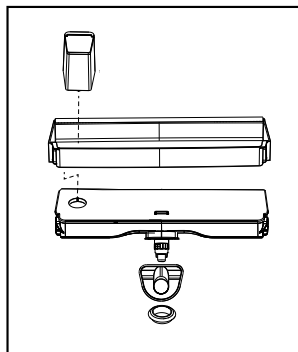
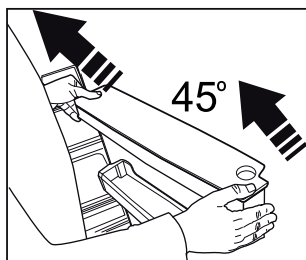
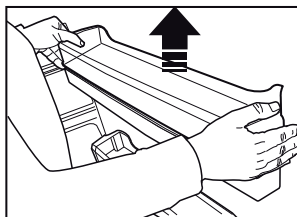
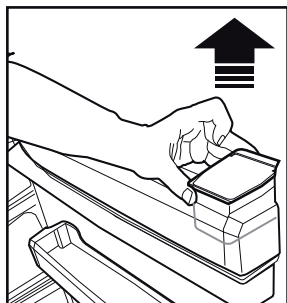
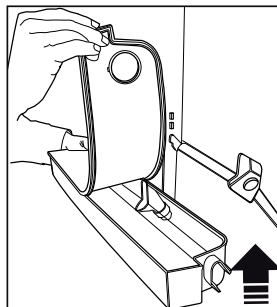

5.15. Drip tray

Water that dripped while using the water dispenser accumulates in the spillage tray.

Remove the plastic filter as shown in the figure.

With a clean and dry cloth, remove the water that has accumulated.

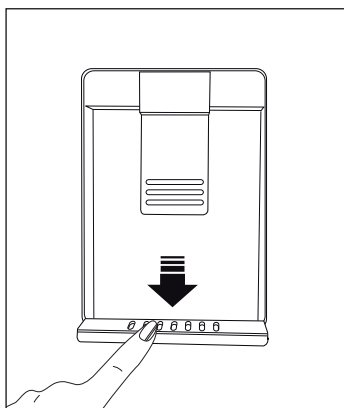

Operating the product

5.16. Everfresh (Humidity-controlled crisper)

(This feature is optional)

Thanks to the humidity-controlled crisper, you can store fruits and vegetables under ideal humidity conditions for a longer time. You can control the humidity inside the refrigerator thanks to the humidity setting system with 3 options, which is located on the front side of the crisper. We recommend you to select the vegetable option when storing vegetables only, fruit option when storing fruits only, and mix option when storing fruits and vegetables at the same time.

To benefit from the humidity control system and increase the storage life of foods, we recommend you not to store your fruits and vegetables in plastic bags. If the vegetables are left inside their bags, this will cause them to decompose in a short period of time. It is especially recommended not to store cucumber and broccoli in plastic bags. In case contacting with other vegetables is not preferred for hygiene concerns, use a perforated brown bag and other similar packaging materials instead of a bag.

While the vegetables are being placed, specific gravity of the vegetables should be taken into consideration. Heavy and hard vegetables should be put at the bottom of the crisper and the lightweight and soft vegetables should be placed over.

Do not place together the pear, apricot, peach, etc. and apple in particular which have a high level of generation of ethylene gas in the same crisper with the other vegetables and fruit. The ethylene gas which is emitted by these fruit may cause the other fruit to ripen faster and decompose in a shorter time.



Operating the product

5.17. Freezing fresh food

- In order to preserve the quality of the food, it shall be frozen as quickly as possible when it is placed in the freezer compartment, use the fast freezing feature for this purpose.
- You may store the food longer in freezer compartment when you freeze them while they are fresh.
- Pack the food to be frozen and close the packing so that it would not allow entrance of air.
- Ensure that you pack your food before putting them in the freezer. Use freezer containers, foils and moisture-proof papers, plastic bags and other packing materials instead of traditional packing papers.
- Label each pack of food by adding the date before freezing. You may distinguish the freshness of each food pack in this way when you open your freezer each time. Store the food frozen before in the front side of compartment to ensure that they are used first.
- Frozen food must be used immediately after they are thawed and they should not be re-frozen.
- Do not freeze too large quantities of food at one time.

Freezer Compartment Setting	Fridge Compartment Setting	Remarks
-18°C	4°C	This is the normal recommended setting.
-20, -22 or -24°C	4°C	These settings are recommended when the ambient temperature exceeds 30°C.
Quick Freeze	4°C	Use when you wish to freeze your food in a short time. Your product will return to its previous mode when the process is over.
-18°C or colder	2°C	Use these settings if you think that your fridge compartment is not cold enough because of the hot ambient conditions or frequent opening and closing of the door.

Operating the product

5.18. Recommendations for preserving the frozen food

Compartment shall be set to -18°C at least.

1. Put packages in the freezer as quickly as possible after purchase without allowing the to thaw.
2. Check whether the "Use By" and "Best Before" dates on the packaging are expired or not before freezing it.
3. Ensure that the package of the food is not damaged.

5.19. Deep-freeze information

According to IEC 62552 standards, the product shall freeze at least 4.5 kg of food at 25°C ambient temperature to -18°C or lower within 24 hours for every 100-litres of freezer volume.

It is possible to preserve the food for a long time only at -18°C or lower temperatures.

You can keep the freshness of food for many months (at -18°C or lower temperatures in the deep freeze).

Foods to be frozen should not be allowed to come in contact with the previously frozen items to prevent them from getting thawed partially.

Boil the vegetables and drain their water in order to store vegetables for a longer time as frozen. After draining their water, put them in air-proof packages and place them inside the freezer. Food such as bananas, tomatoes, lettuce, celery, boiled eggs, potatoes are not suitable for freezing. When these foods are frozen, only their nutritional value and taste shall be affected negatively. They shall not be spoiled so that they would create a risk for human health.

5.20. Placing the food

Freezer compartment shelves	Various frozen food such as meat, fish, ice cream, vegetables and etc.
Refrigerator compartment shelves	Food in pans, covered plates and closed containers, eggs (in closed container)
Door shelves of fridge compartment	Small and packaged food or beverage
Crisper	Vegetables and fruits
Fresh zone compartment	Delicatessen (breakfast food, meat products that shall be consumed in a short time)

5.21. Door open warning

(This feature is optional)

An audio warning signal will be given when the door of your product is left open for 1 minute. This warning will be muted when the door is closed or any of the display buttons (if any) are pressed.

5.22. Illumination lamp

LED lamps are used as illumination lamps. Contact authorized service in case of any problem with this type of light.

The lighting lamps used in this product are not intended for house lighting and not suited to this purpose. The purpose of the lighting lamps in your fridge and/or freezer is to allow you to load your foods in a comfortable and safe manner.

6 Care and Cleaning

Service life of the product will extend and frequently encountered problems will decrease if the product is cleaned periodically.



WARNING: Switch off the product before cleaning.



WARNING: It is recommended to clean the condenser every six months using gloves. You must not use vacuum cleaners.

- Never use gasoline, benzene or similar substances for cleaning purposes.
- Never use any sharp abrasive instruments, soap, household cleaners, detergent or wax polish for cleaning.
- Dissolve one teaspoon of carbonate in half liter of water. Soak a cloth in the solution and wring it thoroughly. Wipe the interior of the refrigerator with this cloth and the dry thoroughly.
- Make sure that no water enters the lamp housing or other electrical parts.
- If you will not use the refrigerator for a long time, unplug it, remove all food inside, clean it and leave the door ajar.
- Check regularly that the door gaskets are clean. If not, clean them.
- Take out all items in the product to remove the door and body shelves.
- Remove the door shelves by pulling them up. Slide the shelves downwards to re-install them after cleaning.
- Never use chloric cleaning agents or water to clean outer surfaces or chrome-coated parts of the product. Chlorine causes abrasion on such metal surfaces.
- For non-No Frost products, water drops and frosting up to a fingerbreadth occur on the rear wall of the Fridge compartment. Do not clean it; never apply oil or similar agents on it.
- Only use slightly damp microfiber cloths to clean the outer surface of the product. Sponges and other types of cleaning cloths may scratch the surface.

6.1. Avoiding Bad Odours

Materials that may cause odour are not used in the production of our refrigerators. However, odour may be emitted if foods are stored improperly or if the inner surface of the product is not cleaned as required. Please consider the following to avoid this problem:

- It is important that the refrigerator is kept clean. Food residuals, stains, etc. can cause odour. For this reason, clean your refrigerator with carbonate solved in water every 15 days. Never use detergents or soap.
- Keep your foods in closed vessels. Microorganisms emitted from vessels without a cover may cause unpleasant odours.
- Never keep expired or spoiled foods in your refrigerator.

6.2. Protection of plastic surfaces

Do not put liquid oils or oil-cooked meals in your refrigerator in unsealed containers as they damage the plastic surfaces of your refrigerator. If oil is spilled or smeared onto the plastic surfaces, clean and rinse the relevant part of the surface with warm water immediately.

6.3. Cleaning the Inner Surface

To clean the inner surfaces and all removable parts, wash them with a mild solution comprising soap, water and carbonate. Rinse and dry thoroughly. Prevent the water from contacting the lighting means and control panel.



ATTENTION:

Do not use vinegar, rubbing alcohol or other alcohol-based cleaning agents on any of the inner surfaces.

6.4. Stainless Steel Outer Surfaces

Use a stainless steel cleaning agent that is non-abrasive and apply it with a lint-free, soft cloth. For polishing, wipe the surface softly with a damp microfiber cloth and use dry wash-leather. Always follow the strands of the stainless steel.

6.5. Cleaning Products with Glass Doors

Remove the protection foil on the glass.

There is a coating on the surface of the glass. This coating minimises stain formation and ensures that stains and dirt are cleaned easily. Glasses that are not protected by a coating might be exposed to permanent bonding of organic or inorganic, air or waterborne pollutants such as limescale, mineral salts, unburned hydrocarbons, metal oxides and silicones, which lead to stains and physical damage in a short time. Despite regular washing, the glass becomes very hard to keep clean, though not impossible. As a result, the clarity and good appearance of the glass reduces. Hard and abrasive cleaning compounds and methods increase these defects even further and accelerate the deterioration process.

*Non-alkali, non-abrasive and water-based cleaning products must be used for routine cleaning procedures. For the coating to have long service life, alkali or abrasive substances must not be used during cleaning processes.

These glasses were subject to a tempering process to increase their impact and breakage resistance.

As an additional safety measure, there is a safety film on the back surfaces of the glasses to ensure that they will not harm the environment in case of breakage.

Please review this list before calling the service. This will save you time and money. This list contains frequently encountered problems that are not results of faulty workmanship or material use. Your product may not have some of the features described here.

The refrigerator is not operating.

- It may not be plugged in properly. >>> Plug in the product properly.
- The fuse of the socket to which your refrigerator is connected or the main fuse may have blown. >>> Check the fuse.

Condensation on the side wall of the fridge compartment (MULTI ZONE, COOL CONTROL and FLEXI ZONE).

- The door may have been opened/closed frequently. >>> Do not open/close the refrigerator door frequently.
- The environment may be too humid. >>> Do not install the refrigerator at locations with a very high level of humidity.
- Foods containing liquid may have been placed into the refrigerator in vessels without covers. >>> Do not place foods containing liquid into the refrigerator in unsealed vessels.
- Door of the refrigerator may have been left ajar. >>> Do not keep the doors of your refrigerator open for a long time.
- The thermostat may have been set to a very cold level. >>> Set the thermostat to an appropriate level.

The compressor is not operating.

- Protective thermal of the compressor will blow out during sudden power failures or plug-out plug-ins as the refrigerant pressure in the cooling system of the refrigerator has not been balanced yet. The refrigerator will start running approximately after 6 minutes. Please call the Authorised Service Provider if the refrigerator does not start at the end of this period.
- The freezer is in defrosting cycle. >>> This is normal for a refrigerator that performs full-automatic defrosting. Defrosting cycle is performed periodically.
- The refrigerator may not be plugged in. >>> Make sure that the plug fits the socket.
- Temperature settings may be incorrect. >>> Select the correct temperature value.
- Possible power failure. >>> The refrigerator will start to operate normally when power restores.

The operation noise increases when the refrigerator is running.

- Operating performance of the refrigerator may vary based on the ambient temperature changes. This is normal and not a fault.

The fridge is running frequently or for a long time.

- Your new product may be bigger than the previous one. Larger refrigerators operate for a longer period of time.
- The room temperature may be high. >>> It is normal that the product operates for longer periods in hot environments.
- The refrigerator may have just been plugged in or loaded with food. >>> It takes the product longer to reach the set temperature when it has just been plugged in or loaded with food. This is normal.
- Large amounts of hot food may have been placed into the refrigerator recently. >>> Do not place hot foods into the refrigerator.
- The doors may have been opened frequently or left ajar for a long time. >>> The warm air that enters the refrigerator causes it to operate for a longer period of time. Do not open the doors frequently.
- Freezer or fridge compartment door may have been left ajar. >>> Check if the doors are closed completely.
- The appliance may be set to a very low temperature. >>> Set the refrigerator temperature to a warmer degree and wait until the product reaches this temperature.
- Door seal of the fridge or freezer compartment may be soiled, worn out, broken or not properly seated. >>> Clean or replace the seal. Damaged/ broken seal causes the refrigerator to run for a longer period of time to maintain the current temperature.

Fridge temperature is adequate but the freezer temperature is very low.

- The freezer compartment temperature may be set to a very low value. >>> Set the freezer compartment temperature to a higher value and check.

Freezer temperature is adequate but the fridge temperature is very low.

- The fridge temperature is adjusted to a very low value. >>> Adjust the fridge temperature to a higher value and check.

Food kept in the fridge compartment drawers is frozen.

Troubleshooting

- The fridge compartment temperature may be set to a very high value. >>> Set the fridge compartment temperature to a lower value and check.

Temperature in the fridge or freezer is very high.

- The fridge compartment temperature may be set to a very high value. >>> Fridge compartment temperature setting has an effect on the temperature of the freezer. Change the temperature of the fridge or freezer compartment until the fridge or freezer compartment temperature reaches an adequate level.
- The doors may have been opened frequently or left ajar for a long time. >>>Do not open the doors frequently.
- The door may have been left ajar. >>>Close the door completely.
- The refrigerator may have been just plugged in or loaded with food. >>>This is normal. It takes the product longer to reach the set temperature when it has just been plugged in or loaded with food.
- Large amounts of hot food may have been placed into the refrigerator recently. >>>Do not place hot foods into the refrigerator.

Vibration or noise.

- The floor may not be stable or level. >>>If the refrigerator shakes when moved slightly, adjust the feet to balance it. Make sure that the floor is level and capable of carrying the refrigerator.
- Objects placed onto the refrigerator may cause noise. >>>Remove the objects on the refrigerator.

There are noises coming from the refrigerator like liquid spilling or spraying.

- Liquid and gas flows occur in accordance with the operating principles of the refrigerator. >>>This is normal and not a fault.

Whistle is heard from the refrigerator.

- There are fans that are used to cool the refrigerator. This is normal and not a fault.

Damp accumulates on the inner walls of refrigerator.

- Hot and humid weather increases icing and condensation. This is normal and not a fault.
- The doors may have been opened frequently or left ajar for a long time. >>>Do not open the doors frequently. Close the doors, if open.
- The door may have been left ajar. >>>Close the door completely.

Humidity occurs on the outer surface of the refrigerator or between the doors.

- Air might be humid. This is quite normal in humid weathers. >>>Condensation will disappear when the humidity level decreases.
- There might be external condensation at the section between two doors of the refrigerator if you use your product rarely. This is normal. Condensation will disappear upon frequent use.

There is a bad odour inside the refrigerator.

- No regular cleaning may have been performed. Clean the inside of the refrigerator with a sponge, lukewarm water or carbonated water.
- Some vessels or packaging materials may cause the odour. >>>Use another vessel, or packaging materials from another brand.
- Foods may have been placed into the refrigerator in vessels without covers. >>>Store the foods in closed vessels. Microorganisms emitted from vessels without a cover may cause unpleasant odours.
- Take out expired or spoiled foods from the refrigerator.

The door cannot be closed.

- Food packages may be preventing the door from closing. >>> Re-locate the packages that are obstructing the door.
- The refrigerator may be unstable on the floor. >>>Adjust the refrigerator feet as required to keep the refrigerator in balance.
- The floor may not be level or solid. >>>Make sure that the floor is level and capable of carrying the refrigerator.

Crispers are stuck.

- Foods may be touching the upper wall of the crisper. >>>Re-organise the foods in the crisper.

If The Surface Of The Product Is Hot.

High temperatures may be observed between the two doors, on the side panels and at the rear grill while the product is operating. This is normal and does not require service maintenance!

Fan keeps running when the door is open.

The fan may keep running when the door of the freezer is open.



WARNING: If you cannot eliminate the problem although you follow the instructions in this section, consult your dealer or the Authorised Service Provider. Never attempt to repair a malfunctioned product.

请首先阅读本手册！

尊敬的顾客，
我们的产品使用先进设备生产，并通过严格的质量控制步骤检测，将为您提供高效的服务。

本《用户手册》将帮助您快速、安全地使用本产品。

- 请务必阅读安全须知。
- 将手册置于触手可及之处，以便随时参考。
- 请阅读产品随附的其它文件。
- 制造商保留对产品进行修改的权利。

请注意，该《用户手册》也适用于其它多种型号。

符号阐释

本《用户手册》中，使用了下列符号：

	重要信息或者有用的使用提示。
	有人身伤害或财产损失风险。
	有触电危险。
	本产品的包装材料根据国家环境规定，采用可回收材料制成。

目录

1 安全和环境说明	3	5.15.承滴盘	23
1.1.一般安全性	3	5.16.如初养鲜 (湿度控制果蔬盒)	24
1.1.1 HC 警告	4	5.17.冷冻新鲜食物	25
1.1.2 针对配有饮水机的型号	4	5.18.储藏冷冻食品的建议	26
1.2.既定用途	4	5.19.深度冷冻信息	26
1.3.儿童安全	5	5.20.放置食物	26
1.4.符合 WEEE 指令和报废产品处置	5	5.21.冰箱门未关警告	26
1.5.符合 RoHS 指令	5	5.22.照明灯	26
1.6.包装信息	5	6 保养和清洁	27
2 冰箱简介	6	6.1.避免异味	27
3 安装	7	6.2.保护塑料表面	27
3.1.适当的安装位置	7	6.3.清洁内表面	27
3.2.安装塑料楔子	7	6.4.不锈钢外表面	27
3.3.调整支腿	7	6 保养和清洁	28
3.4.电气连接	8	6.5.清洁带有 玻璃门的产品	28
4 准备工作	9	7 故障排除	29
4.1.节能措施	9		
4.2.初次使用	9		
5 操作本产品	10		
5.1.指示器面板	10		
5.2.指示器面板	15		
5.3.制冰机	19		
5.4.制冰盒	19		
5.5.冰块盒	19		
5.6.蓝光养鲜	20		
5.7.除臭模块	20		
(FreshGuard)	20		
5.8.离子发生器	20		
5.9.冰温室	21		
5.10.果蔬盒	21		
5.11.可移动的中间部分	21		
5.12.使用饮水机	22		
5.13.给饮水机的水槽加水	22		
5.14.清洗水槽	22		

1 安全和环境说明

本节提供必要的安全指南，以防受伤和材料损坏。未遵守这些指南将使冰箱的各种保修失效。

既定用途

	警告： 确保该电器外壳或者 内置结构中的通风开 口不受任何阻碍。
	警告： 请勿使用机械装置或 者其它手段，加速除 霜过程，除非制造商 建议这样做。
	警告： 请勿损坏制冷剂回 路。
	警告： 请勿在该电器的食物 储藏室使用电气装 置，除非是制造商建 议的类型。

本装置拟用于家庭和类似场合，
例如

- 商店、办公室和其它环境中的
员工厨房区域；
- 农房和在宾馆、汽车旅馆及其
它居住型环境中由客户使用；
- 住宿和早餐型环境中；
- 给养和类似的非零售场合。

1.1. 一般安全性

- **存在身体、感官或精神障碍的人员、缺乏经验和相关使用信息的人士以及儿童不得操作、进入或摆弄本产品。**
- **如果不遵循此类指示，或者对产品的使用不受控，则可能导致严重后果！**
- 若发生故障，拔下插头。
- 拔下插头后，等待至少5分钟，再重新连接插头。

- 不使用时，请拔下插头。
- 请勿用湿手接触插头！拔插头时请勿拉扯电线，而应始终握住插头。
- 如果插座松脱，请勿连接冰箱插头。
- 安装、维护、清洁和修理过程中，应拔下产品插头。
- 若长时间不使用本产品，拔下插头，并取出内部所有食物。
- 电路卡位于产品上方后部（电卡盒盖）（1）的隔室打开时，请勿使用本产品。

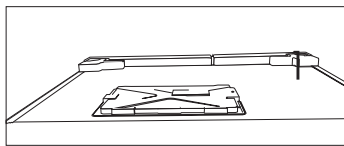
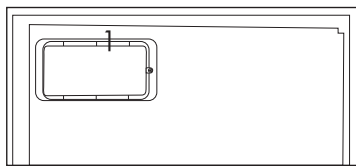

- 切勿使用蒸汽或蒸汽清洁材料清洁冰箱及融化内部冰块。蒸汽可能接触带电区域，并造成短路或触电！
- 清洁本产品时，请勿在上面洒水或倒水！有触电的危险！
- 若发生故障，请勿使用冰箱，否则，可能造成触电。采取任何措施前，请联系授权服务中心。
- 将产品插头插入接地的插座。接地工作必须由具备资格的电工完成。
- 如果产品配置有 LED 类型的灯，如需更换或有任何问题，请与授权服务中心联系。

安全和环境说明

- 请勿用湿手接触冷冻食物！食物可能粘到您的手上！
- 请勿将瓶装或罐装液体放入冷冻室。其可能爆裂！
- 拧紧液体瓶盖后，直立放置。
- 请勿在产品附近喷洒易燃物质，可能着火或爆炸。
- 请勿将易燃材料或装有易燃气体（喷雾等）的物品放入冰箱内。
- 请勿在本产品顶部放置装有液体的容器。水喷溅到电气元件上可能导致发生触电或者火灾危险。
- 本产品淋雨、落雪、受到阳光照射和风吹均会影响到电气安全。重新摆放本产品时，请勿抓握门把手拉拽。把手可能会脱落。
- 小心您的双手或身体的任何部位不要被冰箱内的移动零件卡住。
- 请勿踩踏或倚靠在冰箱的门、抽屉或类似部位。这可能会造成本产品倾倒，并损坏部件。
- 小心不要缠住电线。

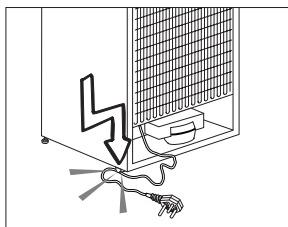

1.1.1 HC 警告

如果冰箱包含使用 R600a 气体的制冷系统，使用和移动冰箱

时，小心避免损坏制冷系统及其管道。此气体易燃。如果制冷系统损坏，本产品应远离火源，并立即对房间通风。



本产品使用的气体类型在位于冰箱内部左壁上的标签上注明。

1.1.2 针对配有饮水机的型号

- 冷水入口压力最高为 90 psi (620 kPa)。如果水压超过 80 psi (550 kPa)，在主系统中，使用压力限制阀。如果不知道如何检查水压，可以寻求专业水管工的帮助。
- 如果安装环境有水击的风险，请务必使用水击防止设备。如果不确定安装环境是否有水击效应，请咨询专业的水管工。
- 请勿在热水入口安装。采取措施，防止软管冻结。水温操作间隔最低 33° F (0.6° C)，最高 100° F (38° C)。
- 只能使用饮用水。

1.2. 既定用途

- 本产品设计供家庭使用。不用于商业用途。
- 本产品应用来存放食物和饮料。
- 请勿将需要控制温度的敏感产品（疫苗、对温度变化敏感的药物、医用材料等）放入冰箱内。
- 制造商对使用不当或处理不当造成的损坏不承担任何责任。
- 自购买之日起的 10 年内，我们将提供原装备件。

安全和环境说明

1.3. 儿童安全

- 包装材料经置于儿童不可及之处。
- 儿童不得摆弄本产品。
- 如果冰箱门上有锁，钥匙应置于儿童不可及之处。

1.4. 符合 WEEE 指令

和报废产品处置

本产品符合 EU WEEE 指令 (2012/19/EU)。本产品带有报废电子电器设备 (WEEE) 的分类符号。



本产品采用可以重复利用和适合回收的优质零件和材料制成。在本产品使用寿命结束时，请勿将其作为日常的生活垃圾和其他废物进行处置。应将其送至回收电器电子设备的收集中心。有关这

些收集中心的信息，请咨询当地的权力机构。

1.5. 符合 RoHS 指令

- 本产品符合 EU WEEE 指令 (2011/65/EU)。其不含有该指令中指定的有害和禁用材料。

1.6. 包装信息

- 本产品的包装材料根据国家环境规定，采用可回收材料制成。包装材料不得与生活垃圾或其他废物一起处置。应将其送至当地机构指定的包装材料回收点。

2 冰箱简介

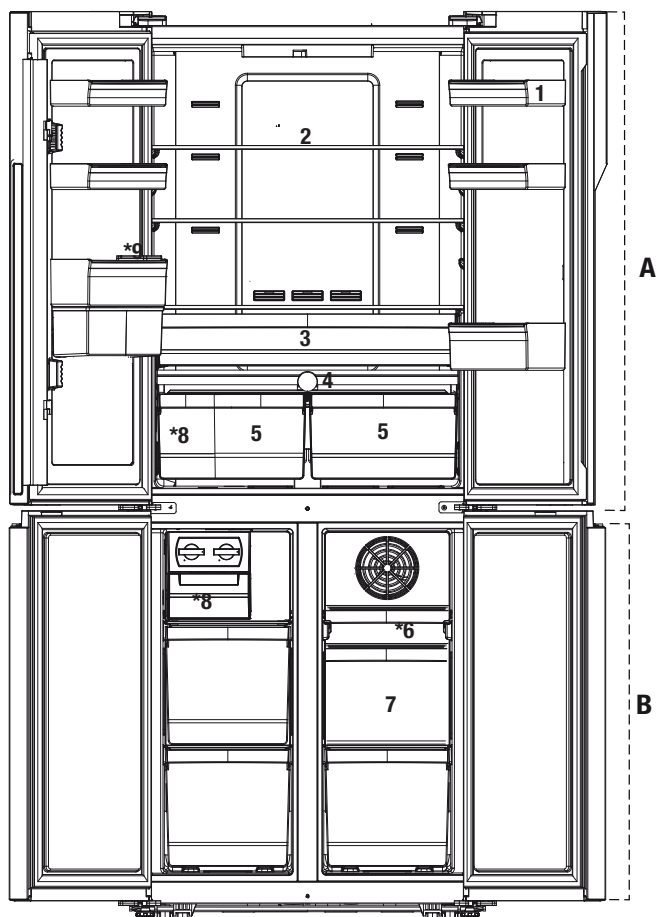

A- 冷藏室

B- 冷冻室

- 1- 冷藏室门搁架
- 2- 冷藏室玻璃搁架
- 3- 冰温室
- 4- 保鲜室
- 5- 果蔬盒

- 6- 冷冻室活动抽屉
- 7- 冷冻室抽屉
- 8- 自动制冰盒
- 9- 贮水器

可能不适用于所有型号。



本手册中的插图均为示例，可能与您的产品有所不同。如果相关零件未包含在您购买的产品当中，插图适用于其它型号。

3.1. 适当的安装位置

请联系授权服务中心安装本产品。产品准备使用时，请参考用户手册中的信息，并确保水电连接适当。否则，请安排具有资质的电工和技工，实施必要的安排。



警告：对于由未经授权之人员实施的步骤导致的损坏，制造商不承担任何责任。



警告：安装期间，本产品插头不得插入电源。否则，有导致死亡或严重受伤的危险！



警告：如果要安装产品的房间的门底净空较小，导致产品无法通过，请联系授权的服务机构。

- 将产品放置在平坦的地面，防止晃动。
- 如果要产品安装在柜体/家具中，侧壁与柜体/家具之间需预留至少 2 cm 的间距。
- 产品安装位置距离热源（例如，炉盘、中央加热器和炉灶）至少 30 cm，距离电烤箱至少 5 cm。
- 安装后，产品不得受到阳光直射，亦不得处于潮湿的环境中。
- 在产品周围必须有适当的通风，以便获得高效的冷却。如果冰箱放置在墙壁内的凹口，距离天花板和侧墙必须至少 5 cm。**对于未配备塑料楔子的型号，确保与后墙之间保持 5 cm 的间距。**
- 若室温下降到 10 °C 以下，冰箱会继续运行，以保持冷冻室中的食品质量。但是，冷藏室中的新鲜食物可能会因低温而结冰。

3.2. 安装塑料楔子

产品附带的塑料楔子用于在产品与后部墙壁之间提供必要的距离，促进空气流通。

1. 方法是，拆下本产品上的螺丝，并使用随楔子一起提供的螺丝。

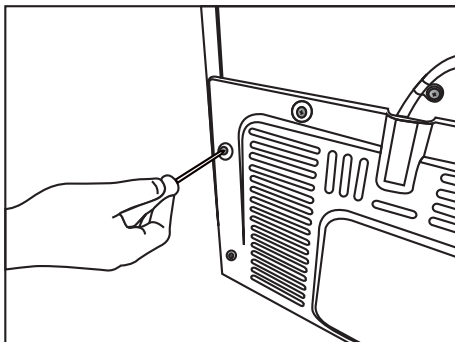

2. 如图所示，在后部通风口罩盖插入 2 个塑料楔子。

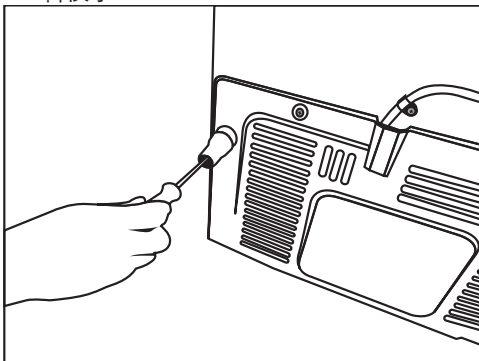

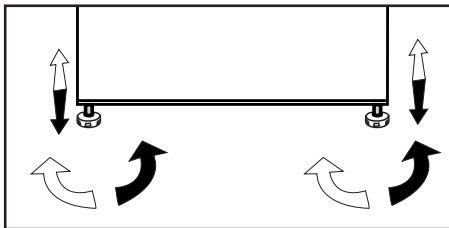

3.3. 调整支腿

安装后，如果产品不稳，可以调整支腿，向左或向右转动。



3.4. 电气连接

	警告：请勿通过扩充电缆或多用插头连接。
	警告：受损的电源线必须由授权服务代理更换。
	如果并排安装两台冰箱，必须至少间隔 4 cm。

- 本产品必须根据国家规定，在接地的情况下使用，否则，如果发生任何损坏，我公司不承担任何责任。
- 安装后，电源线插头必须触手可及。
- 在产品与墙壁插座之间，请勿使用加长电线或无绳多用插座。

	表面发热警告！ 产品侧壁配备制冷剂管道，以改善制冷系统。高温液体可能会流经此类表面，导致侧壁上的表面发热。这是正常现象，无需进行维修。触碰此等区域时请小心。
---	--

4.1. 节能措施



将本产品连接到节能系统会有危险，可能导致本产品损坏。

- 请勿长时间敞开冰箱门。
- 请勿在冰箱内放置灼热的食物或饮料。
- 冰箱不可装入过多食物，内部空气循环受到阻碍时，制冷能力将下降。
- 如需最大化冰箱冷藏室的容量，可拆除制冰盒和冰储藏容器，将其置于玻璃搁架上方。冰箱声明的耗电量是在拆除制冰盒、冰储藏容器以及上方和中间抽屉，放置最大数量的食物的情况下确定的。高度建议装入时使用下方的抽屉。
- 视乎产品功能而定，在冷藏室为冷冻的食物解冻具有节能的效果，并可以有效保持食品质量。
- 放置食物时，注意不要阻碍冷冻室风扇前部的气流。放入的食物与保护风扇隔栅前部至少留出 5cm 空间。
- 避免冷冻室温度传感器和食物包装之间直接接触。如果传感器和包装之间接触，产品能耗会增加。



必须清洁冰箱内部。



如果并排安装两台冰箱，必须至少间隔 4 cm。

4.2. 初次使用

开始使用冰箱前，请务必根据“安全和环境说明”以及“安装”章节中的说明，确保做好所有准备工作。

在不放入任何食物的情况下，冰箱运转 6 小时，且不开冰箱门，除非另外要求。



当压缩机启动时，您会听到噪声。即使压缩机没有运转，制冷系统中密封的液体和气体也可能产生噪声，这是正常现象。



冰箱前端边缘发热是正常的。这些区域特意采用了保温设计，以免发生冷凝。

5.1. 指示器面板

指示器面板视您产品型号之不同而异。

指示器面板上的声音和可视功能帮助您高效使用冰箱。

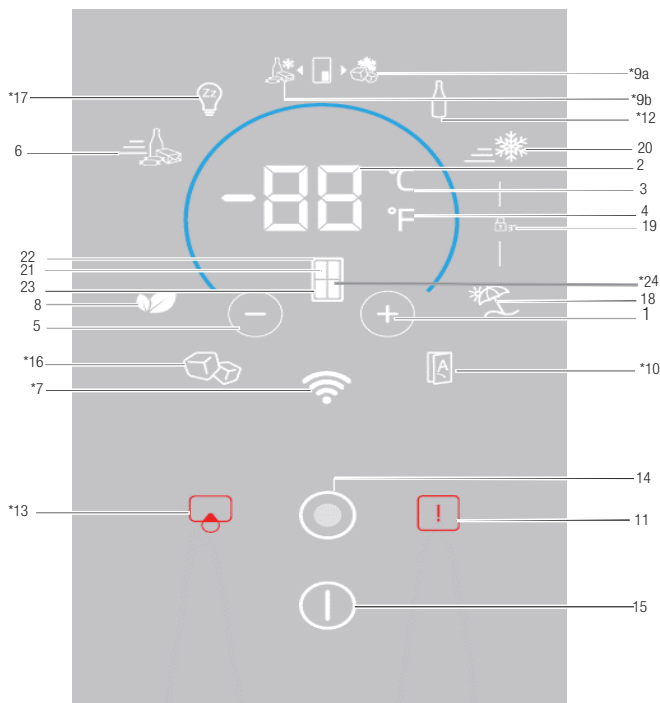

- | | |
|-------------------------|-------------------|
| 1. 温度设置/温度升高 | 14. 菜单按钮 |
| 2. 温度设置滑块/温度值指示器 | 15. 产品开启/关闭指示器/按钮 |
| 3. 温度单位选择 (° C) 摄氏度指示器 | 16. *制冰盒指示器/按钮 |
| 4. 温度单位选择 (° F) 华氏温度指示器 | 17. *休眠模式 |
| 5. 温度设置/温度降低 | 18. 闲置模式指示器/按钮 |
| 6. 快速制冷功能指示器/按钮 | 19. 键锁 指示器 |
| 7. * 无线 | 20. 快速冷冻功能指示器/按钮 |
| 8. 节能模式指示器/按钮 | 21. 间室体选择 |
| 9. *变温室/ 冷冻室指示器/按钮 | 22. 冷藏室指示器 |
| 10. *自动门 | 23. 冷冻室指示器 |
| 11. 高温警告/故障 | 24. *变温室/隔室指示器 |
| 12. *饮料瓶制冷器 | |
| 13. *过滤器更换警告/按钮 | |

可能不适用于所有型号。



***可选：** 本手册中的插图均为示例，可能与您的产品有所不同。如果相关零件未包含在您购买的产品当中，插图适用于其它型号。

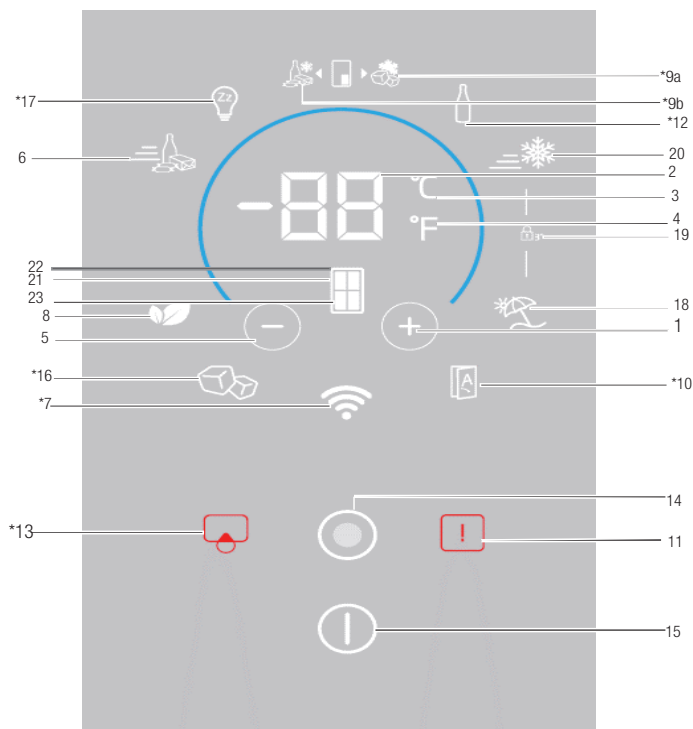

- | | |
|-------------------------|-------------------|
| 1. 温度设置/温度升高 | 14. 菜单按钮 |
| 2. 温度设置滑块/温度值指示器 | 15. 产品开启/关闭指示器/按钮 |
| 3. 温度单位选择 (° C) 摄氏度指示器 | 16. *制冰盒指示器/按钮 |
| 4. 温度单位选择 (° F) 华氏温度指示器 | 17. *休眠模式 |
| 5. 温度设置/温度降低 | 18. 闲置模式指示器/按钮 |
| 6. 快速制冷功能指示器/按钮 | 19. 键锁 指示器 |
| 7. * 无线 | 20. 快速冷冻功能指示器/按钮 |
| 8. 节能模式指示器/按钮 | 21. 间室选择 |
| 9. *变温室/ 冷冻室指示器/按钮 | 22. 冷藏室指示器 |
| 10. *自动门 | 23. 冷冻室指示器 |
| 11. 高温警告/故障 | |
| 12. *饮料瓶制冷器 | |
| 13. *过滤器更换警告/按钮 | |

可能不适用于所有型号。



***可选：** 本手册中的插图均为示例，可能与您的产品有所不同。如果相关零件未包含在您购买的产品当中，插图适用于其它型号。

操作本产品

1. 温度设置/温度升高

按下后可升高所选隔室的温度。

2. 温度设置滑块/温度值指示器

显示所选隔室的温度值。此外，您还可采用自上而下或自下而上的方式滑动手指，升高或降低温度值。

3. 温度单位选择 (°C)

摄氏度指示器

按下此按钮后，将激活摄氏度温度值。

这是摄氏度指示器。激活摄氏度指示后，设置的温度值将以摄氏度显示，相应图标会完全亮起，而华氏温度图标的亮度为 50%。

4. 温度单位选择 (°F)

华氏温度指示器

按下此按钮后，将激活华氏温度值。其为华氏温度指示器。激活华氏温度指示后，设置的温度值将以华氏温度显示，相应图标会完全亮起，而摄氏度图标的亮度为 50%。

5. 温度设置/温度降低

按下后可降低所选隔室的温度。

6. 快速制冷功能指示器

激活快速制冷功能后，指示器会完全亮起。取消此功能后，产品会返回到常用设置，指示器的亮度变为 50%。

快速制冷功能按钮

用于激活或解除“快速制冷”功能。



在您希望快速冷却放置在冷藏室的食物时，使用快速制冷功能。如果您想冷却大量的新鲜食物，将食物放入冰箱前，激活该功能。



如果您没有取消，“快速制冷”功能将在最多 8 小时后或在冷藏室达到要求的温度后自行取消。



如果您快速多次按下“快速制冷”按钮，电路电子保护系统将启动，所以，压缩机将不会立即启动。



断电后，在电源恢复时，该功能不会重新调用。

7. 无线

按下此按钮后，产品将会首次引进家庭网络。激活此功能后，指示器将完全亮起；取消该功能后，指示器的亮度变为 50%。

8. 节能指示器/按钮

按下此按钮以激活/解除经济模式。激活经济模式后，指示器会完全亮起。若已激活此功能，冷冻室至少在 6 小时后开始以经济模式运行。取消此功能后，指示器的亮度变为 50%。

9a. *变温室/冷冻室指示器/按钮

按下此按钮后，变温室/隔室将发挥冷冻室的作用，指示器会完全亮起。变温室/冷藏室指示器的亮度为 50%。

9b. 变温室/冷藏室指示器/按钮

按下此按钮后，变温室/隔室将发挥冷藏室的作用，指示器会完全亮起。变温室/冷冻室指示器的亮度为 50%。

10.* 自动门

按下此按钮以激活/解除自动门模式。激活此功能后，指示器会完全亮起。取消此功能后，指示器的亮度变为 50%。

在功能激活期间，触碰门把手的对应部位即可自动打开冰箱门。

11. 高温警告/故障

在电源故障、高温故障和错误警告期间，此指示器亮起。电源长期故障期间，冷冻室达到的最高温度将在数字显示屏上闪烁。检查冷冻室中的食物后，按下高温警告按钮，清除警报。

操作本产品

12. *饮料瓶制冷器

按下此按钮以激活/解除饮料瓶制冷器模式。

激活此功能后，指示器会完全亮起。
取消此功能后，指示器的亮度变为 50%。

13. *过滤器更换警告/按钮

过滤器需要重置时，该图标亮起。

按下此按钮后，过滤器会进行重置，重置图标会熄灭。

14. 菜单按钮

使用此按钮将显示屏切换为睡眠模式或取消睡眠模式。如果您在 30 秒内未按下任何按钮或打开冰箱门，会自动切换至睡眠模式。

15. 产品开启/关闭指示器/按钮

如需开启/关闭产品，按下并按住开启/关闭按钮 3 秒。

关闭产品后，仅开启/关闭指示器完全亮起，所有其它指示器均会熄灭。如需开启产品，按下并按住同一按钮 3 秒。冰箱将启动，开启/关闭指示器的亮度变为 50%。

16. *制冰盒指示器/按钮

按下此按钮以激活/解除制冰盒。如果指示器完全亮起，表明制冰盒正在运行。如果指示器的亮度为 50%，表明制冰盒已关闭。



不选择该功能时，来自水槽的水流将停止。但是，可以从制冰盒取出之前制的冰。

17. *休眠模式

按下此按钮以激活/解除安息日模式。激活此功能后，指示器会完全亮起。取消此功能后，指示器的亮度变为 50%。

18. 闲置模式指示器/按钮

按下此按钮以激活闲置模式；闲置模

式指示器会完全亮起。闲置功能活动时，温度值显示屏上出现“-”，且冷藏室不执行制冷。在该功能启动时，不适宜在冷藏室存放食物。其他隔室将根据设置的温度继续制冷。

若要取消该功能，再次按下闲置功能按钮。取消此功能后，指示器的亮度变为 50%。

19. 键锁指示器

同时按下快速制冷和闲置按钮 3 秒。按下按钮时，温度值显示屏上会开始倒计时。键锁激活后，键锁指示器会完全亮起，键锁模式将激活。如果键锁模式活动，按钮将不工作。再次同时按下快速制冷和闲置按钮 3 秒。按下按钮时，温度值显示屏上会开始倒计时。取消键锁后，键锁指示器的亮度变为 50%，键锁模式将解除。

如果希望阻止修改冰箱的温度设置，可以激活该功能。

20. 快速冷冻功能指示器

激活快速冷冻功能后，指示器会完全亮起。取消此功能后，产品会返回到常用设置，指示器的亮度变为 50%。

快速冷冻功能按钮

用于激活或解除快速冷冻功能。

按下该按钮，激活或解除快速冷冻功能。激活该功能时，冷冻室将冷却至低于预设值的温度。



您希望快速冷冻放在冷冻室的食物时，使用快速冷冻功能。如果您想冷冻大量的新鲜食物，将食物放入冰箱前，请激活该功能。

操作本产品



如果您不取消该功能，则快速冷冻功能将在至多 4 小时后或者在冷藏室达到所需温度后自动取消。



断电后，在电源恢复时，该功能不会重新调用。

21. 间室选择

按下柜体选择按钮以在温度值指示器上查看和更改冷藏室和冷冻室的温度值。

22. 冷藏室指示器

此指示器活动时，冷藏室的温度会显示在温度值指示器上。

23. 冷冻室指示器

此指示器活动时，冷冻室的温度会显示在温度值指示器上。

24. *变温室 隔室指示器

此指示器活动时，*变温室 冷冻室的温度会显示在温度值指示器上。

5.2. 指示器面板

指示器面板视您产品型号之不同而异。

指示器面板上的声音和可视功能帮助您高效使用冰箱。

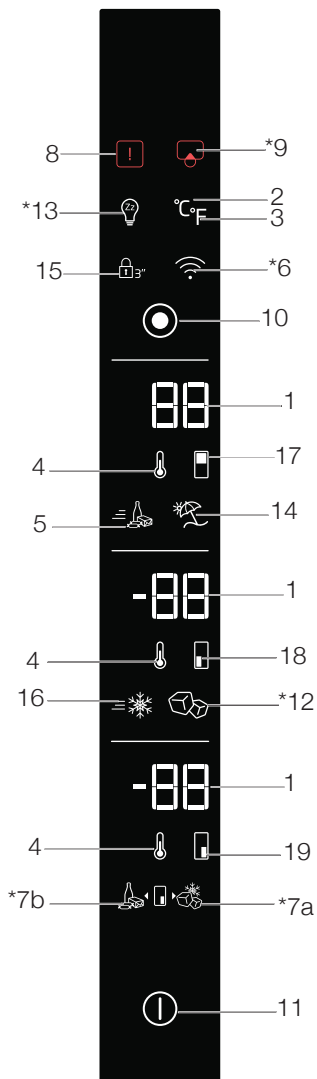

可能不适用于所有型号。



*可选：本手册中的插图均为示例，可能与您的产品有所不同。如果相关零件未包含在您购买的产品当中，插图适用于其它型号。

操作本产品

1. 温度设置滑块/温度值指示器
2. 温度单位选择 (° C) 摄氏度指示器
3. 温度单位选择 (° F) 华氏温度指示器
4. 温度设置/温度降低
5. 快速制冷功能指示器/按钮
6. * 无线
7. *变温室/ 冷冻室指示器/按钮
8. 高温警告/故障
9. *过滤器更换警告/按钮
10. 菜单按钮

11. 产品开启/关闭指示器/按钮
12. *制冰盒指示器/按钮
13. *休眠模式
14. 闲置模式指示器/按钮
15. 键锁 指示器
16. 快速冷冻功能指示器/按钮
17. 冷藏室指示器
18. 冷冻室指示器
19. *变温室/隔室指示器

1.温度设置滑块/温度值指示器

显示所选隔室的温度值。此外，您还可采用自上而下或自下而上的方式滑动手指，升高或降低温度值。

2.温度单位选择 (° C)

摄氏度指示器

按下此按钮后，将激活摄氏度温度值。这是摄氏度指示器。激活摄氏度指示后，设置的温度值将以摄氏度显示，相应图标会完全亮起，而华氏温度图标的亮度为 50%。

3.温度单位选择 (° F)

华氏温度指示器

按下此按钮后，将激活华氏温度值。其为华氏温度指示器。激活华氏温度指示后，设置的温度值将以华氏温度显示，相应图标会完全亮起，而摄氏度图标的亮度为 50%。

4.温度设置/温度降低

按下后可降低所选隔室的温度。

5.快速制冷功能指示器

激活快速制冷功能后，指示器会完全亮起。取消此功能后，产品会返回到常用设置，指示器的亮度变为 50%。

快速制冷功能按钮

用于激活或解除“快速制冷”功能。



在您希望快速冷却放置在冷藏室的食物时，使用快速制冷功能。如果您想冷却大量的新鲜食物，将食物放入冰箱前，激活该功能。



如果您没有取消，“快速制冷”功能将在最多 8 小时或在冷藏室达到要求的温度后自行取消。



如果您快速多次按下“快速制冷”按钮，电路电子保护系统将启动，所以，压缩机将不会立即启动。



断电后，在电源恢复时，该功能不会重新调用。

6.无线

按下此按钮后，产品将会首次引进家庭网络。激活此功能后，指示器将完全亮起；取消该功能后，指示器的亮度变为 50%。

7a. *变温室/冷冻室指示器/按钮

按下此按钮后，变温室/ 隔室将发挥冷冻室的作用，指示器会完全亮起。变温室/冷藏室指示器的亮度为 50%。

7b. 变温室/冷藏室指示器/按钮

按下此按钮后，变温室/隔室将发挥冷藏室的作用，指示器会完全亮起。变温室/冷冻室指示器的亮度为 50%。

操作本产品

8. 高温警告/故障

在电源故障、高温故障和错误警告期间，此指示器亮起。电源长期故障期间，冷冻室达到的最高温度将在数字显示屏上闪烁。检查冷冻室中的食物后，按下高温警告按钮，清除警报。

9. *过滤器更换警告/按钮

过滤器需要重置时，该图标亮起。

按下此按钮后，过滤器会进行重置，重置图标会熄灭。

10. 菜单按钮

使用此按钮将显示屏切换为睡眠模式或取消睡眠模式。如果您在 30 秒内未按下任何按钮或打开冰箱门，会自动切换至睡眠模式。

11. 产品开启/关闭指示器/按钮

如需开启/关闭产品，按下并按住开启/关闭按钮 3 秒。

关闭产品后，仅开启/关闭指示器完全亮起，所有其它指示器均会熄灭。如需开启产品，按下并按住同一按钮 3 秒。冰箱将启动，开启/关闭指示器的亮度变为 50%。

12. *制冰盒指示器/按钮

按下此按钮以激活/解除制冰盒。如果指示器完全亮起，表明制冰盒正在运行。如果指示器的亮度为 50%，表明制冰盒已关闭。



不选择该功能时，来自水槽的水流将停止。但是，可以从制冰盒取出之前制的冰。

13. *休眠模式

按下此按钮以激活/解除安息日模式。激活此功能后，指示器会完全亮起。取消此功能后，指示器的亮度变为 50%。

14. 闲置模式指示器/按钮

按下此按钮以激活闲置模式；闲置模式指示器会完全亮起。闲置功能活动时，温度值显示屏上出现“- -”，且冷藏室不执行制冷。在该功能启动

时，不适宜在冷藏室存放食物。其他隔室将根据设置的温度继续制冷。

若要取消该功能，再次按下闲置功能按钮。取消此功能后，指示器的亮度变为 50%。

15. 键锁指示器

同时按下快速制冷和闲置按钮 3 秒。按下按钮时，温度值显示屏上会开始倒计时。键锁激活后，键锁指示器会完全亮起，键锁模式将激活。如果键锁模式活动，按钮将不工作。再次同时按下快速制冷和闲置按钮 3 秒。按下按钮时，温度值显示屏上会开始倒计时。取消键锁后，键锁指示器的亮度变为 50%，键锁模式将解除。

如果希望阻止修改冰箱的温度设置，可以激活该功能。

16. 快速冷冻功能指示器

激活快速冷冻功能后，指示器会完全亮起。取消此功能后，产品会返回到常用设置，指示器的亮度变为 50%。

快速冷冻功能按钮

用于激活或解除快速冷冻功能。

按下该按钮，激活或解除快速冷冻功能。激活该功能时，冷冻室将冷却至低于预设值的温度。



您希望快速冷冻放在冷冻室的食物时，使用快速冷冻功能。如果您想冷冻大量的新鲜食物，将食物放入冰箱前，请激活该功能。



如果您不取消该功能，则快速冷冻功能将在至多 4 小时后或者在冷藏室达到所需温度后自动取消。



断电后，在电源恢复时，该功能不会重新调用。

操作本产品

17.冷藏室指示器

此指示器活动时，冷藏室的温度会显示在温度值指示器上。

18.冷冻室指示器

此指示器活动时，冷冻室的温度会显示在温度值指示器上。

19.*变温室 隔室指示器

此指示器活动时，*变温室 冷冻室的温度会显示在温度值指示器上。

5.3. 制冰机

(该功能可选)

使用制冰机可以轻松地利利用冰箱制冰。

使用制冰机

1. 取出冷藏室中的水槽。
2. 在水槽中充满水。
3. 放回水槽。第一批冰块在大约四小时后于位于冷冻室的制冰机抽屉中制作完毕。



如果完全充满水槽，可以获得大约 60-70 个冰块。



应每 2-3 周更换一次水槽中的水。

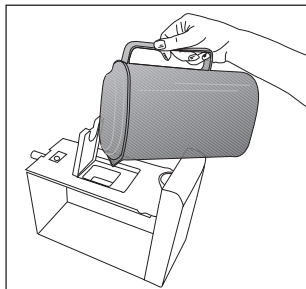
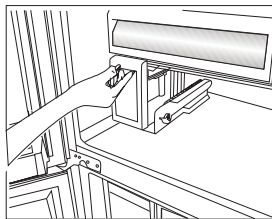
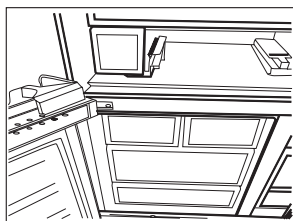

5.4. 制冰盒

(该功能可选)

使用制冰盒可以轻松地利利用冰箱制冰。

制冰盒使用方法

1. 小心向外拉，取出制冰盒。
2. 在制冰盒中放满水。
3. 将制冰盒放回原位。大约两小时后，冰块制作完毕。
4. 如需取出冰块，将冰容器的旋钮顺时针转动 90°。容器中的冰块将掉落到下面的冰储藏容器中。
5. 您可以取出冰储藏容器，并开始使用冰块。



取出冰块时，不得从底座取下制冰盒。



您也可以根据需求，将冰块保留在冰储藏容器中。冰储藏容器仅用于收集冰块。请勿在里面放水。否则，其可能破裂。

5.5. 冰块盒

(该功能可选)

使用制冰盒可以轻松地利利用冰箱制冰。

使用冰块盒

1. 从冷冻室取出冰块盒。
2. 在冰块盒中充满水。
3. 将冰块盒放入冷冻室。大约两小时后，冰块制作完毕。
4. 从冷冻室取出冰块盒，并在检修板上方弯曲之。冰块将很容易掉落到检修板上。

操作本产品

5.6. 蓝光养鲜

(该功能可选)

本产品的果蔬盒使用蓝色光照明。在果蔬盒中储存的食物通过蓝色光的波长效应，继续它们的光合作用，从而保持其新鲜度。

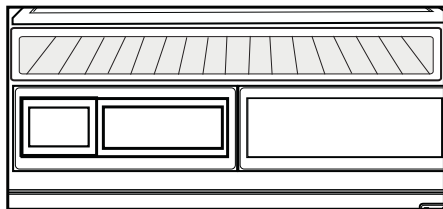

5.7. 除臭模块 (FreshGuard)

(该功能可选)

除异味模块可迅速地消除冰箱中的难闻气味，以免它们渗入食物表面。借助设立于新鲜食物隔间顶部的此模块，空气将在异味过滤器上活跃地传递，同时难闻的气味将被消除，而经过滤器净化后的空气随后将重新排放到新鲜食物隔间中。这样，存储食物期间可能在冰箱中产生的异味将在渗入食物表面之前即被消除。

这一切的实现可归功于此模块中的风扇、LED 和异味过滤器。在日常使用中，除异味模块将定期每 48 小时自动激活 2 小时。

由于整合了风扇，在操作过程中听到噪音属于正常现象。如果在此模块处于激活状态的情况下打开新鲜食物隔间的门，风扇将暂时停止工作，并且将在门再次关闭时继续操作。如发生断电，除异味模块将在通电恢复时从断电状态恢复操作，直至总运行时间达到 2 小时。

提示信息：建议将带有香气的食物（例如乳酪、橄榄和熟食）存储在其包装中并密封，以免当不同食品的气味混合在一起时可能产生异味。为了保证其他食物的安全和异味的产生，我们建议您尽快将可能已经变坏的食物从冰箱中取出。



5.8. 离子发生器

(可选)

冷藏室空气管内的离子发生器系统用于对空气进行离子化。释放出的负离子将清除造成空气发臭的细菌和其他微生物。

5.9. 冰温室

(该功能可选)

使用此隔室存放那些应该低温存放的熟食，或稍后将食用的肉制品。请勿在此隔室存放水果或蔬菜。

您可以通过拆除冰温室，增大冰箱内的容量。

拉动隔室直至其无法移动，然后将其上提并朝自己拉动即可将其拆除。

5.10. 果蔬盒

冰箱的果蔬盒专门设计保持蔬菜的新鲜度，而不会失去水分。对此，一般情况下，在果蔬盒周围发生冷空气流通。将水果和蔬菜存放进此隔室。为延长绿叶蔬菜的保存时间，请将其与水果分开存放。

5.11. 可移动的中间部分

可移动的中间部分既定用于防止冰箱内的冷空气逸出。

1- 在关闭冷藏室的门之后，冰箱门上的垫圈挤压可移动中间部分的表面，从而提供密封。

2- 冰箱配备有可移动中间部分的另一个原因是，其可以增加冷藏室的净容量。标准的中间部分占据冰箱某些无用的空间。

3-在关闭冷藏室左侧的门之后，可移动中间部分关闭。

4-不得手动开启。在门关闭后，其在机体上的塑料零件的引导下移动。

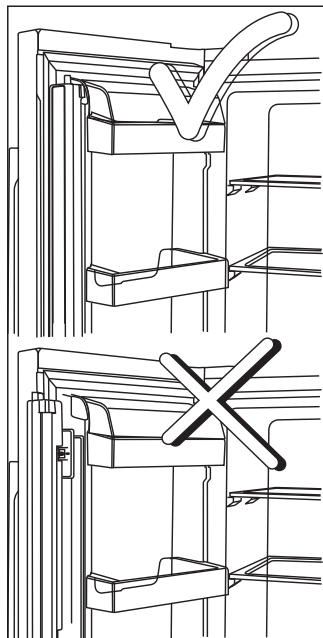

操作本产品

5.12. 使用饮水机

(该功能可选)



最初从饮水机接出的几杯水没有降温是正常的。



如果长时间没有使用饮水机，废弃最初的几杯水，而后便可以获得洁净的水。

1. 用杯子推入饮水机的控制杆。如果使用软塑料杯，用手推动控制杆将更容易。
2. 杯子填充至需要的水位后，释放控制杆。

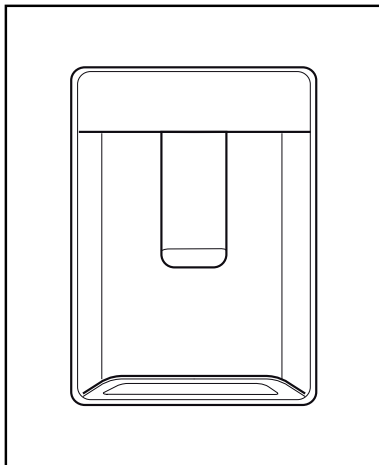

请注意，饮水机的水流取决于您压下控制杆的距离。随着茶杯/杯子中的水位上升，逐渐减少控制杆上的压力，以免水溢出。如果您轻微按下控制臂，会有水滴；这是正常的，并非故障。

5.13. 给饮水机的水槽加水

水槽加水容器位于冰箱门支架内。

1. 打开水槽的盖子。
2. 在水槽中加入新鲜的饮用水。

3. 关闭盖子。



请勿在水槽加入除饮用水以外的任何其它液体；果汁、含二氧化碳的饮料或酒精饮料等不适合使用饮水机。如果使用这些类型的液体，饮水机将彻底损坏。此类损坏不在保修范围内。这些类型的饮料/液体中包含的某些化学物质和添加剂可能会损坏水槽。



只能使用清洁的饮用水。



水槽容量为 3 升；请勿过度装满。

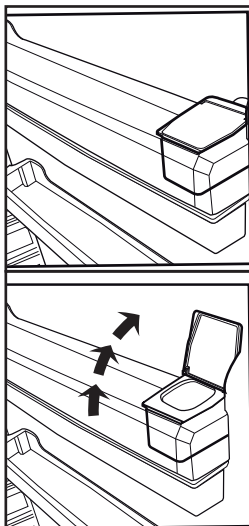

5.14. 清洗水槽

1. 拆卸冰箱门支架内的加水容器。
2. 从两侧固定，拆卸冰箱门支架。
3. 从两边握住水槽，并以 45° 的角度，拆卸之。
4. 拆卸水槽盖子，并清洁水槽。



请勿在洗碗机中清洗水槽部件和饮水机。

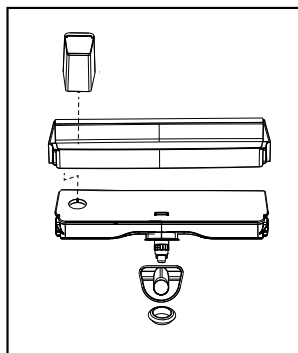
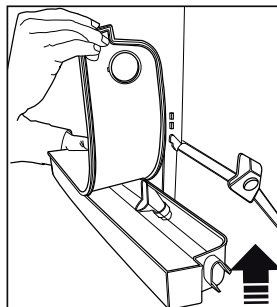
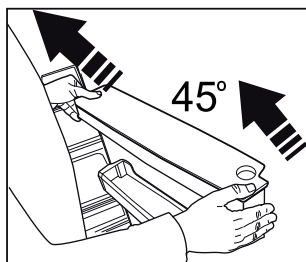
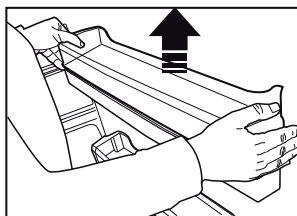
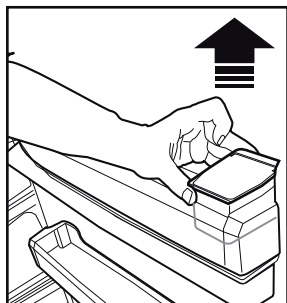

5.15. 承滴盘

使用饮水机过程中滴落的水收集在承滴盘中。

如图所示，拆卸塑料滤网。

使用清洁和干燥的抹布，擦干收集的水。

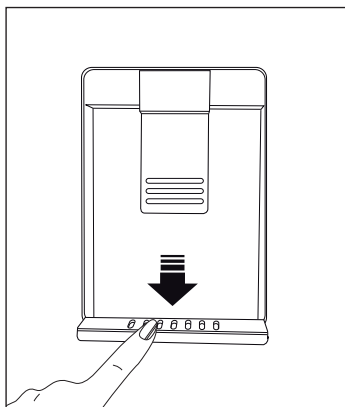

5.16. 如初养鲜 (湿度控制果蔬盒)

(该功能可选)

借助湿度控制果蔬盒，可将水果和蔬菜存放在理想的湿度环境中，从而延长保存时间。可使用湿度设置系统控制冰箱内部的湿度，此系统位于果蔬盒的正面，提供 3 个选项。我们的建议设置为：仅存放蔬菜时选择蔬菜选项；仅存放水果时选择水果选项；同时存放水果和蔬菜时选择混合选项。为受益于湿度控制系统并延长食品的保存时间，我们建议您不要将水果和蔬菜存放在塑料袋中。如果蔬菜留在袋子中，将在短时间内腐烂。尤其建议您不要将黄瓜和西兰花存放在塑料袋中。出于卫生原因，如果不希望与其它蔬菜接触，可以使用带孔的棕色食品纸袋或其它类似包装材料，代替塑料袋。

放置蔬菜时，应考虑蔬菜的比重。较重和较硬的蔬菜应放在果蔬盒底部，轻质、较软的蔬菜应放在顶部。

请尤其注意不要将梨、杏、桃和苹果等具有较高乙烯气体生成水平的水果与其它蔬菜和水果一起放在同一果蔬盒内。此类水果产生的乙烯气体，会导致其它水果更快成熟，腐烂变质的速度更快。



操作本产品

5.17. 冷冻新鲜食物

- 为保持食物品质，放入冷冻室的食物应尽快冷冻，可以使用快速冷冻功能。
 - 在食物新鲜的时候即冷冻，可以在冷冻室放置更长时间。
 - 包装需要冷冻的时候，并关闭包装，确保没有空气进入。
 - 放入冰箱前，请务必对食物加以包装。使用冷冻容器、铝箔和防湿纸，塑料袋和其他包装材料，代替传统的包装纸。
 - 标记每个食物包，注明冷冻前的日期。通过这种方式，每次打开冰箱时，可以区分每个食物包装的新鲜度。将之前冷冻的食物放置在冷冻室的前部，确保首先消耗之。
- 冷冻食物在解冻后必须立即使用，不得重新冷冻。
 - 请勿一次冷冻大量食物。

冷冻室设置	冷藏室设置	备注
-18° C	4° C	这是正常的建议设置。
-20、-22 或 -24° C	4° C	环境温度超过 30° C 时，建议使用这些设置。
快速冷冻	4° C	在您希望短时间冷冻食物时使用。在这一过程结束后，冰箱将恢复之前的模式。
-18° C 或更冷	2° C	如果您认为冷藏室不够冷是由于高温条件或者经常打开和关闭冰箱门所致，则可以使用这些设置。

5.18. 储藏冷冻食品的建议

冷冻室温度至少设置为 -18°C 。

1. 在购买后，尽快将食物放入冷冻室，避免解冻。
2. 冷冻前，请检查包装上的“使用截止”和“最佳食用”日期。
3. 确保食物包装完好。

5.19. 深度冷冻信息

根据 IEC 62552 标准，对于每 100 升的冷冻容量，冰箱在 25°C 的环境温度，在 24 小时内将至少 4.5 kg 食物冷冻至 -18°C 或以下。

只有在 -18°C 或更低的温度，才能将食物保存较长时间。

您可以在数个月的时间内使食物保持新鲜（深度冷冻至 -18°C 或更低的温度）。

即将冷冻的食物不得与之前冷冻的食物相接触，以免部分解冻。

蔬菜用开水焯一下，并控干，可以在冷冻室存放更长时间。水控干后，将蔬菜放置在不透气的包装内，而后放入冰箱。香蕉、西红柿、生菜、芹菜、煮蛋、土豆和等食物不能冷冻。如果冷冻这些食物，营养价值和口感都会受到不良影响。最终可能给人体健康带来风险。

5.20. 放置食物

冷冻室搁架	各种冷冻食物，例如，肉、鱼、冰淇淋，蔬菜等。
冰箱搁架	放在盘子、盖板和密闭容器内的食物、蛋（在密闭容器中）
冷藏室门搁架	小包食物或饮料
果蔬盒	蔬菜和水果
保鲜区	熟食（短时间内食用的早餐食物、肉制品）

5.21. 冰箱门未关警告

（该功能可选）

在冰箱门打开超过 1 分钟时，会发出声音警报信号。关闭冰箱门或按下任何显示按钮（如果有）时，警报将静音。

5.22. 照明灯

LED 灯用作照明灯。如果此类灯具出现任何问题，请联系授权的服务机构。

本产品中使用的照明灯，不供家居照明之用，亦不适用于此等用途。冷藏室和/或冷冻室中的照明灯，旨在让您放入食品时感到舒适、安全。

如果定期清洁本产品，其使用寿命将会延长，且常见问题将会减少。



警告：进行清洁之前，请关闭本产品。



警告：建议您每六个月使用手套清洁一次冷凝器。您不可使用真空吸尘器。

- 切勿使用汽油、苯或类似物质进行清洁。
- 切勿使用任何锋利的磨具、肥皂、家用清洁剂、洗涤剂或蜡抛光剂进行清洁。
- 将一茶匙碳酸盐溶解在半升水中。将抹布浸泡在溶液中，然后彻底拧干。使用此抹布擦拭冰箱内部，然后待其彻底干燥。
- 确保没有水渗入灯壳或其他电气部件。
- 如果您将长时间不使用冰箱，则请拔下其插头，取出其中的所有食物，清洁冰箱，并使冰箱门保持半开状态。
- 定期检查冰箱门垫圈是否干净。如果不干净，请清洁它们。
- 取出本产品中的所有物品，以便拆下冰箱门的箱体搁架。
- 向上拉起冰箱门搁架，以将其拆下。清洁完成后，向下滑动搁架以重新安装它们。
- 切勿使用含氯清洁剂或水清洁本产品的外表面或镀铬部件。氯会导致此类金属表面磨损。
- 对于非无霜型产品，冷藏室的后壁会出现水滴和最大可达一指宽度的霜花。请勿对后壁进行清洁；切勿向后壁涂抹油类或类似制剂。
- 只能使用略微润湿的超细纤维布清洁产品的外表面。海绵和其他类型的清洁布可能会刮伤该表面。

6.1. 避免异味

我们没有采用可能会产生异味的材料来制造冰箱。但是，如果食物存储不当，或您未按照要求清洁本产品的内表面，则冰箱中可能会散发异味。请考虑以下各项以避

免此问题：

- 必须保持冰箱干净，这一点非常重要。食物残余、污渍等都可能产生异味。因此，请使用碳酸盐溶解水每 15 天清洁一次冰箱。切勿使用洗涤剂或肥皂。
- 请食物存储在封闭的容器内。无盖容器中释放出的微生物可能产生难闻的气味。
- 切勿在冰箱中保存过期或变质食物。

6.2. 保护塑料表面

请勿将非密封容器中盛放的液体油或者用油烹饪的食物放入冰箱，这类食物可能损坏冰箱的塑料表面。如果食用油飞溅或者涂抹在塑料表面上，立即用温水，清洁和洗涤表面的相关部分。

6.3. 清洁内表面

若要清洁内表面和所有可拆卸部件，请使用含有肥皂、水和碳酸盐的温和溶液清洗它们。彻底冲洗并干燥。防止水接触照明工具和控制面板。



注意：

请勿在任何内表面上使用醋、外用酒精或其他醇基清洁剂。

6.4. 不锈钢外表面

请使用非磨损性不锈钢清洁剂，并使用无绒软布涂抹。为了确保抛光效果，请用打湿的超细纤维布轻轻擦拭表面，并使用干洗皮革。请务必沿着不锈钢的股线进行清洁。

6.5. 清洁带有 玻璃门的产品

除去 玻璃 上的 保护 箔。

玻璃 表面 上具 有 一 层 涂 层。此 涂 层 可 最 大 限 度 地 防 止 污 渍 形 成，并 确 保 污 渍 和 污 垢 可 以 轻 松 地 清 除。不 受 涂 层 保 护 的 玻 璃 可 能 被 有 机 或 无 机 的 空 气 中 或 水 中 的 污 染 物（如 石 灰 石、矿 物 盐、未 燃 烧 的 碳 氢 化 合 物、金 属 氧 化 物 和 硅）永 久 附 着，这 会 在 短 时 间 内 导 致 污 渍 和 物 理 损 坏。尽 管 经 常 清 洗，但 玻 璃 仍 会 变 得 很 难 保 持 干 净，当 然 这 并 不 意 味 着 完 全 不 可 能。因 此，玻 璃 的 清 洗 性 和 美 观 度 都 会 受 到 不 利 影 响。硬 质 和 磨 蚀 性 清 洁 化 合 物 和 方 法 会 增 加 这 些 缺 陷，甚 至 加 剧 和 加 速 劣 化 过 程。

*执 行 日 常 清 洁 程 序 时，必 须 使 用 非 碱 性、非 磨 损 性 和 水 基 清 洁 产 品。

为 了 使 涂 层 具 有 长 久 的 使 用 寿 命，不 得 在 清 洁 过 程 中 使 用 碱 性 或 磨 蚀 性 物 质。

这 些 玻 璃 都 接 受 过 回 火 处 理 以 提 高 其 抗 冲 击 性 和 抗 破 裂 性。

作 为 一 项 额 外 的 安 全 措 施，玻 璃 背 面 贴 有 一 层 安 全 薄 膜，可 确 保 玻 璃 在 破 裂 时 不 会 对 环 境 造 成 危 害。

联系服务人员之前，请检查此清单。这样做将节省您的时间和金钱。此清单包括与工艺和材料故障无关的一些常见的投诉。这里提及的某些功能可能不适用于您的产品。

冰箱不工作。

- 电源插头没有插好。>>> 将插头完全插入插座中。
- 连接到为冰箱提供电源的插座的保险丝或主电源保险丝已烧断。>>> 检查保险丝。

冷藏室侧壁上出现冷凝水（多功能区、冷藏区、控制区和变温区）。

- 环境过冷。>>> 请勿将产品安装在温度低于 -5°C 的环境中。
- 冰箱门打开过于频繁 >>> 不要过于频繁地打开冰箱门。
- 环境过于潮湿。>>> 请勿将冰箱安装在潮湿的环境中。
- 内含液体的食品保存在未密封的容器中。>>> 请将内含液体的食品保存在密封的容器中。
- 冰箱门一直打开。>>> 请勿长时间敞开冰箱门。
- 自动调温器设置为过低的温度。>>> 将自动调温器设置到适当的温度。

压缩机不工作。

- 在突然断电或者拔下和插入接头时，冰箱制冷系统中的气体压力尚未平衡，从而触发压缩机的热保护。冰箱将在大约 6 分钟后重新启动。如果冰箱此后没有重新启动，请联系服务人员。
- 除霜功能正在运行。>>> 对于全自动除霜产品而言，这是正常的。除霜功能会定期运行。
- 冰箱插头没有插好。>>> 确保电源线已插好。
- 温度设置不正确。>>> 选择正确的温度设置。
- 电源已断开。>>> 电源恢复后，冰箱会继续正常工作。

使用过程中冰箱的运行噪音逐渐增大

- 由于环境温度的变化，冰箱的运行性能可能会存在差异。这是正常的，并非故障。

冰箱运行过于频繁或时间过长。

- 新产品可能会比以前的产品大。较大的产品需要更长的运行时间。
- 室温可能较高。>>> 在较高室温下，冰箱通常需要较长的时间来运行。
- 冰箱插头可能刚插入不久或刚装入新的食品。>>> 冰箱插头刚插入不久或刚装入新的食品时，可能需要更长的时间才能达到设定的温度。这是正常的。
- 最近可能在冰箱中放入了大量热的食品。>>> 请勿将热的食品放入冰箱中。
- 冰箱门经常打开或长时间敞开。>>> 进入冰箱内部的热空气导致冰箱运行时间较长。请勿经常打开冰箱门。
- 冷冻室或冷藏室的门可能没有关严。>>> 检查确保这些门已经完全关闭。
- 冰箱可能设置为过低的温度。>>> 将温度设置为更高并等待冰箱到达调节好的温度。
- 冷藏室或冷冻室的门密封圈可能较脏、磨损、开裂或未适当固定好。>>> 清洁或更换密封圈。损坏/开裂的门密封圈将导致冰箱运行较长的时间才能保持当前的温度。

冷冻室温度很低，而冷藏室温度足够。

- 冷冻室的温度设置为很低。>>> 调高冷冻室的温度并再次检查。

冷藏室温度很低，而冷冻室温度足够。

- 冷藏室的温度设置为很低。>>> 调高冷藏室的温度并再次检查。

保存在冷藏室抽屉内的食品被冻住了。

- 冷藏室的温度设置为很低。>>> 调高冷冻室的温度并再次检查。

冷藏室或冷冻室内的温度过高。

故障检修

- 冷藏室的温度设置为很高。>>> 冷藏室的温度设置会影响冷冻室的温度。变更冷藏室或冷冻室的温度并等待，直到冷藏室或冷冻室达到调节好的温度水平。
- 冰箱门经常打开或长时间敞开。>>> 请勿过于频繁打开冰箱门。
- 冰箱门可能未关严。>>> 完全关闭冰箱门。
- 冰箱插头可能刚插入不久或刚装入新的食品。>>> 这是正常的。冰箱插头刚插入不久或刚装入新的食品时，可能需要更长的时间才能达到设定的温度。
- 最近可能在冰箱中放入了大量热的食品。>>> 请勿将热的食品放入冰箱中。

振动或噪音。

- 地面不平坦或不坚固。>>> 如果冰箱缓慢移动时产生晃动，请调节支脚来平衡冰箱。同时确保地面足够坚固，能够承载冰箱。
- 放置在冰箱上的任何物品均可能导致噪音的产生。>>> 取下放置在冰箱上的任何物品。

产品发出类似液体流动、喷溅等的噪音。

- 根据原理，冰箱工作时会涉及液体和气体的流动。>>> 这是正常的，并非故障。

产品发出类似风吹的噪音。

- 冰箱使用风扇来进行冷却。这是正常的，并非故障。

产品内壁出现冷凝水。

- 炎热或潮湿的天气会增加结冰和冷凝现象。这是正常的，并非故障。
- 冰箱门经常打开或长时间敞开。>>> 请勿过于频繁打开冰箱门；如果门已打开，请关上。
- 冰箱门可能未关严。>>> 完全关闭冰箱门。

产品外面或门之间出现冷凝水。

- 周围空气可能很潮湿，在潮湿气候下，这是很正常的。>>> 湿度下降时，冷凝水将会消失。

内部出现异味。

- 没有定期清洁冰箱。>>> 使用海绵、热水和苏打水定期清洁冰箱内部。
- 某些容器和包装材料可能会产生异味。>>> 使用没有异味的容器和包装材料。
- 食品放置在未密封的容器中。>>> 将食品保存在密封的容器中。没有密封的食品可能会散发出微生物，并造成异味。
- 从冰箱中取出任何已过期或变质的食品。

冰箱门未关。

- 食品包装袋可能妨碍冰箱门的关闭。>>> 重新放置妨碍关门物品。
- 冰箱在地面上没有处于完全竖立位置。>>> 调节支脚以平衡冰箱。
- 地面不平坦或不坚固。>>> 确保地面足够坚固，能够承载冰箱。

蔬菜盒已卡住。

- 食品可能已接触到抽屉的顶板。>>> 重新摆放抽屉中的食品。



警告：如果遵循本节中的指示操作后，问题仍然存在，请联系您的供货商或经过授权的服务人员。请勿自己尝试修理产品。

Altus 冰箱变频压缩机十年质保卡

感谢您选购高品质的 Altus 产品。

本产品的冰箱变频压缩机享有延长保修政策，零件免费保修期为十年。

延长保修条款：

1. 保修条款仅对产品购买所在国家有效。
2. 保修范围为：
 - Altus 冰箱变频压缩机自购买之日起的 10 年内免费保修。
 - 免费范围包括一个免费备件，不包括人工费和交通费。
3. 如果保修卡不完整、遭到篡改或有缺陷无法识别，其视为无效。
4. 申请保修服务时，请同时出示购机发票及此质保凭证。
5. 保修仅适用于原始购买人，不得转让给任何第三方。
6. 免责条款：符合下列情形之一，不享受延保服务：
 - 不正当的运输、安装、使用环境、操作导致的损坏
 - 自然灾害或意外事件等不可抗力导致的损坏
 - 自行或非厂方特约维修店进行拆修导致的损坏
 - 在商业或非住宅设施内商用或集体使用本产品
 - 其他不符合说明书保修条款的情形

- 以上信息如有更改，恕不另行通知，以官方网站为准。

***以上条款仅限变频压缩机型号**

**BU SAYFA FTP_AKÜ ENERJİ ADRESİNDEN
MATBAA TARAFINDAN ALINARAK BASILACAKTIR.**

